

## 90° OUTSIDE U-SHAPE WINDOW: BLOCK FRAMES

330-T, 350-T, 450-T & 3800-T

U:\Cadfiles\_Admin\Products\Windows (9/13/23)

CUSTOMER:

ORDER NO.:

SERIES:

ITEM NO.:

**PLAN VIEW**  
SERIES 350-T SHOWN

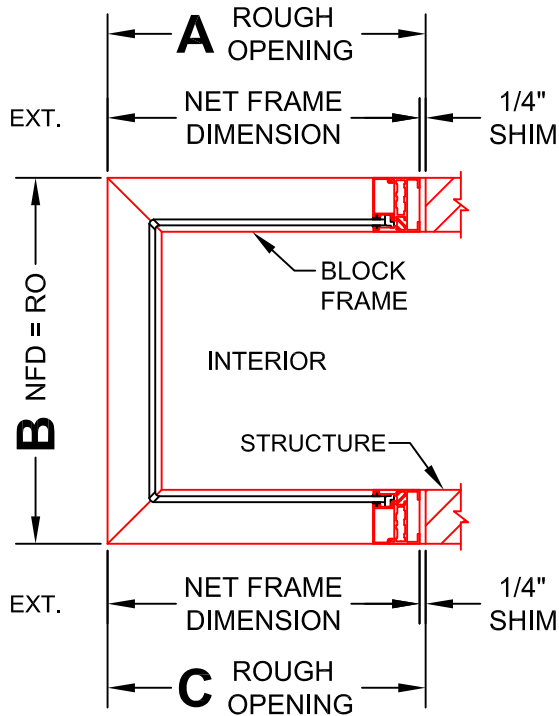

**ISOMETRIC VIEW**  
90° OUTSIDE U-SHAPE STRUCTURE

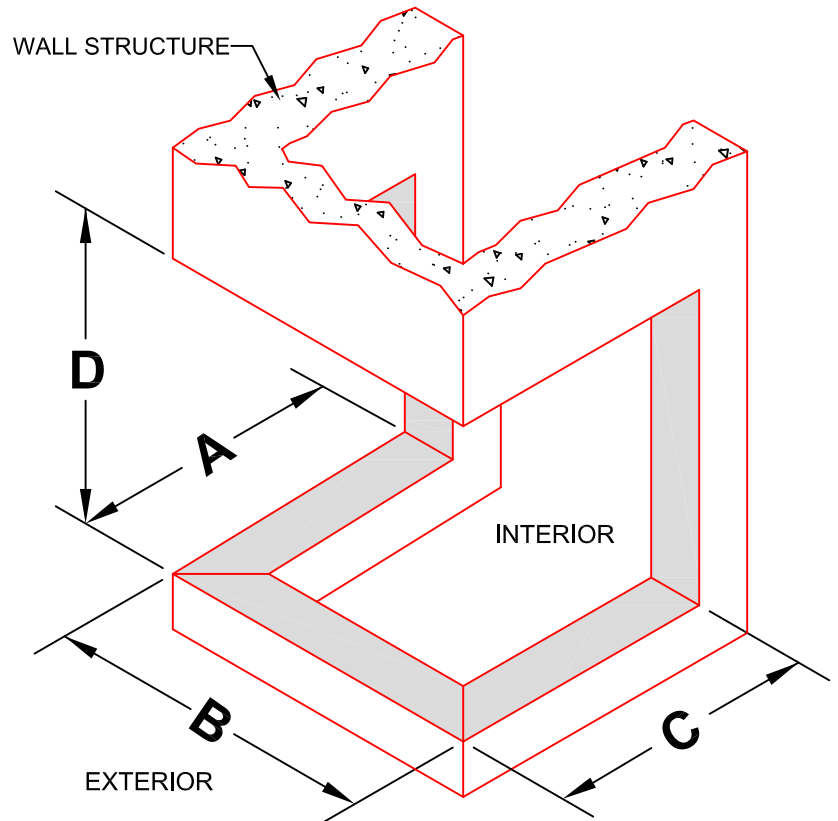

**NOTES:**

- 1) FRAME TO BE INSTALLED FLUSH TO EXTERIOR LINE.
- 2) \*IMPORTANT: 450-T SHIM SPACE VARIES PER WINDOW TYPE - (FIXED OUTSIDE GLAZED = .25"); (FIXED INSIDE GLAZED, P.O. w/BUTT HINGE, AND P.I. = .50"); (P.O. w/4-BAR HINGE = .625"). NOTE: 2X FOR DIM. REF. D

**INSTRUCTIONS: ENTER THE (4) RO (ROUGH OPENING) DIMENSIONS IN THE TABLE AND CALCULATE REQUIRED N.F.D. BELOW.  
ENTER BUILDING EXTERIOR DIMENSIONS ONLY!**

DIM. REF.	CUSTOMER ROUGH OPENING		SHIM DEDUCT		FLEETWOOD NET FRAME DIMENSION
<b>A</b>		-	.25*	=	
<b>B</b>		-	0	=	
<b>C</b>		-	.25*	=	
<b>D</b>		-	.50*	=	

CUSTOMER SIGNATURE:

DATE: