

[Product Specifications](#)  
[Click Here](#)



(USE RULER TO SCALE DIMENSIONS IN INCHES)

SCALE: 1/4"

## WINDOW INSERTS

1  
HORIZONTAL  
TDL

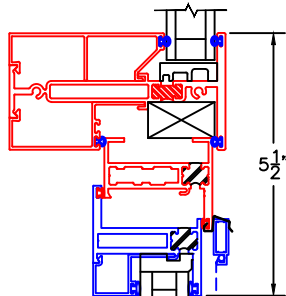

EXTERIOR

3  
HORIZONTAL  
TDL

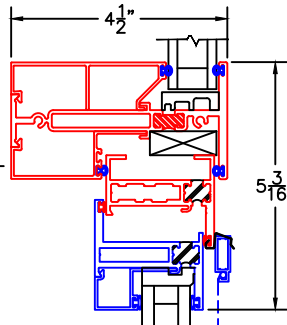

EXTERIOR

5  
HORIZONTAL  
TDL

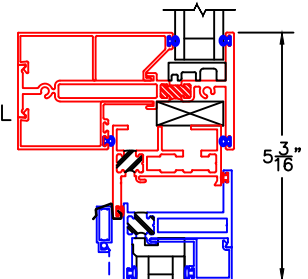

EXTERIOR

2  
BLOCK SILL  
W/ SILL PAN

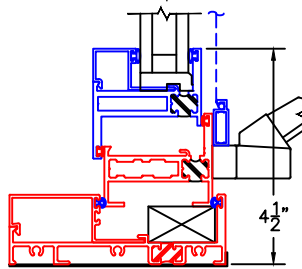

3800-T 1" GLAZING OVER  
350-T 1" GLAZING  
CASEMENT

4  
BLOCK SILL  
W/ SILL PAN

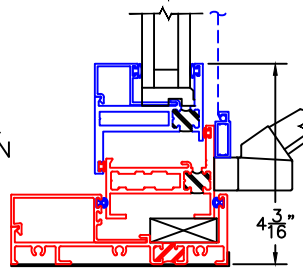

3800-T 1" GLAZING OVER  
350-T 1" GLAZING  
AWNING

6  
BLOCK SILL  
W/ SILL PAN

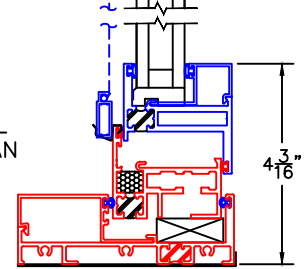

3800-T 1" GLAZING OVER  
350-T 1" GLAZING  
HOPPER

7  
BLOCK  
JAMB

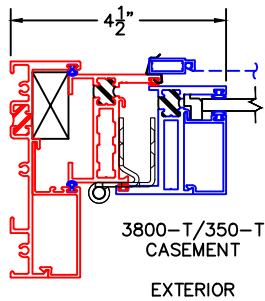

3800-T/350-T  
CASEMENT  
EXTERIOR

8  
BLOCK  
JAMB

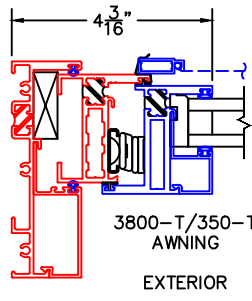

3800-T/350-T  
AWNING  
EXTERIOR

9  
BLOCK  
JAMB

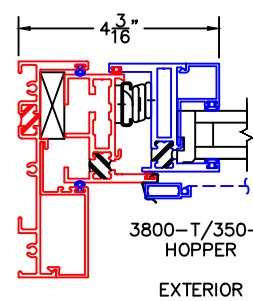

3800-T/350-T  
HOPPER  
EXTERIOR

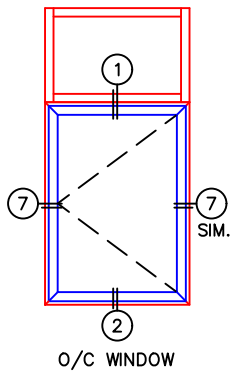

O/C WINDOW

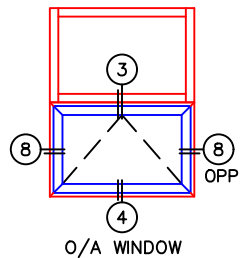

O/A WINDOW

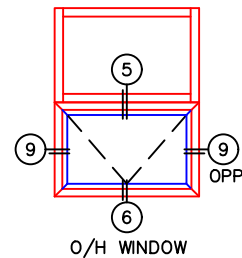

O/H WINDOW

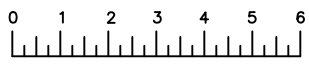

(USE RULER TO SCALE DIMENSIONS IN INCHES)  
**SCALE: 1/4**

## WINDOW INSERTS

[Architecturals Click Here](#)   [Parts List Click Here](#)

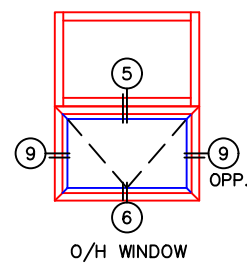
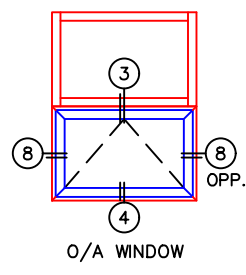
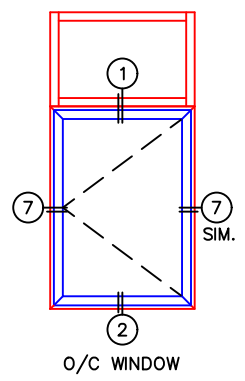
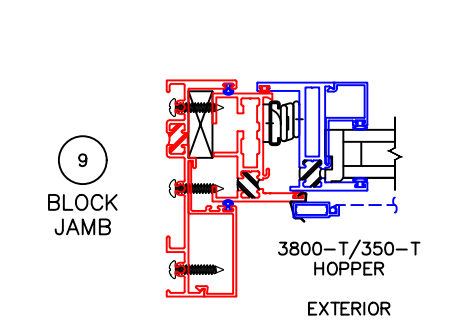
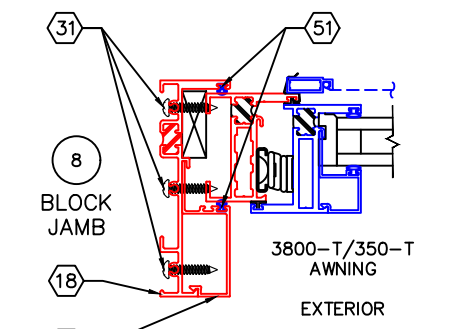
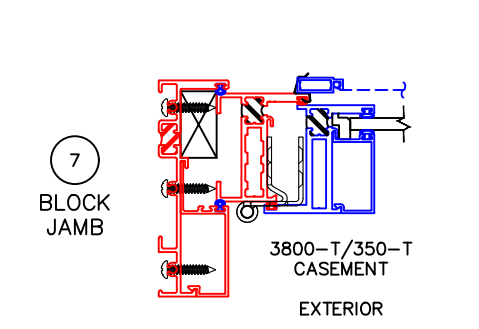
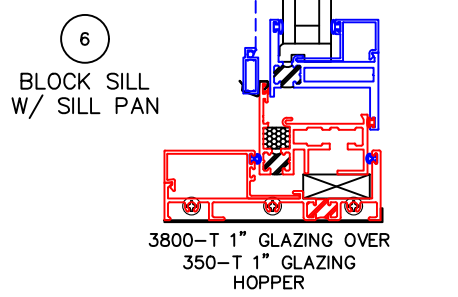
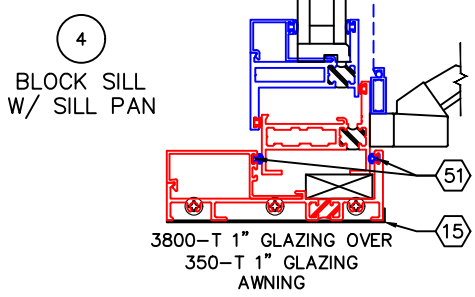
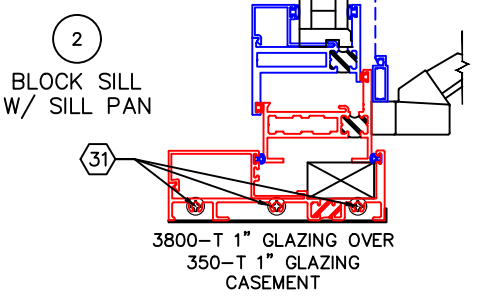
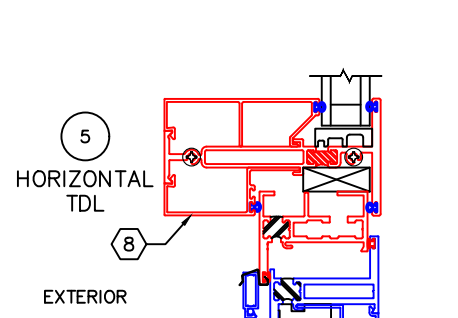
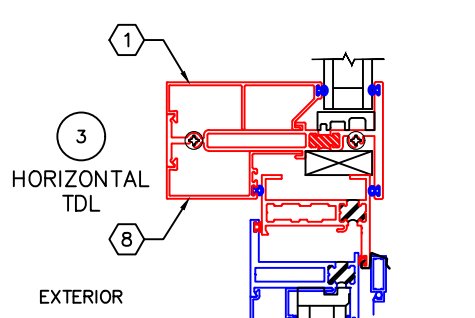
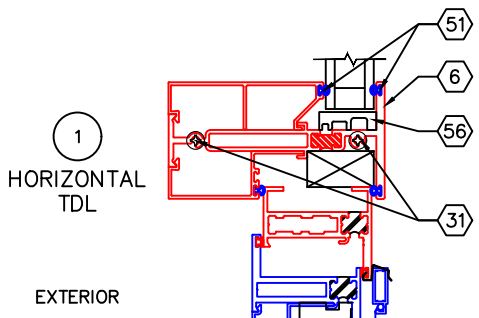

0 0.5 1  
(USE RULER TO SCALE DIMENSIONS IN INCHES)  
**SCALE: FULL**

WINDOW INSERT DETAILS  
1" INSULATED GLAZING

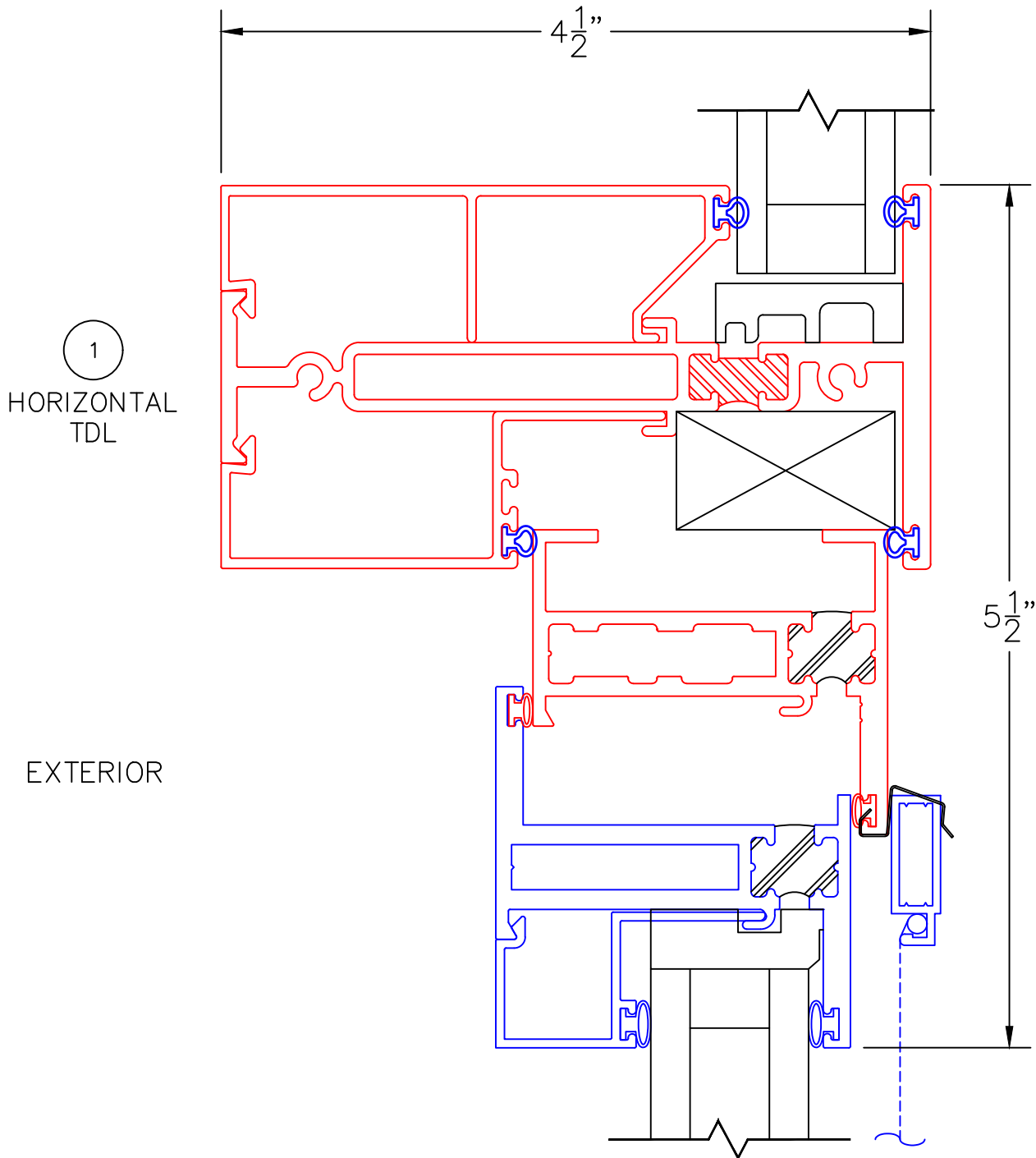

3800-T 1" GLAZING OVER  
350-T CASEMENT INSERT

0 0.5 1  
(USE RULER TO SCALE DIMENSIONS IN INCHES)  
**SCALE: FULL**

WINDOW INSERT DETAILS  
1" INSULATED GLAZING

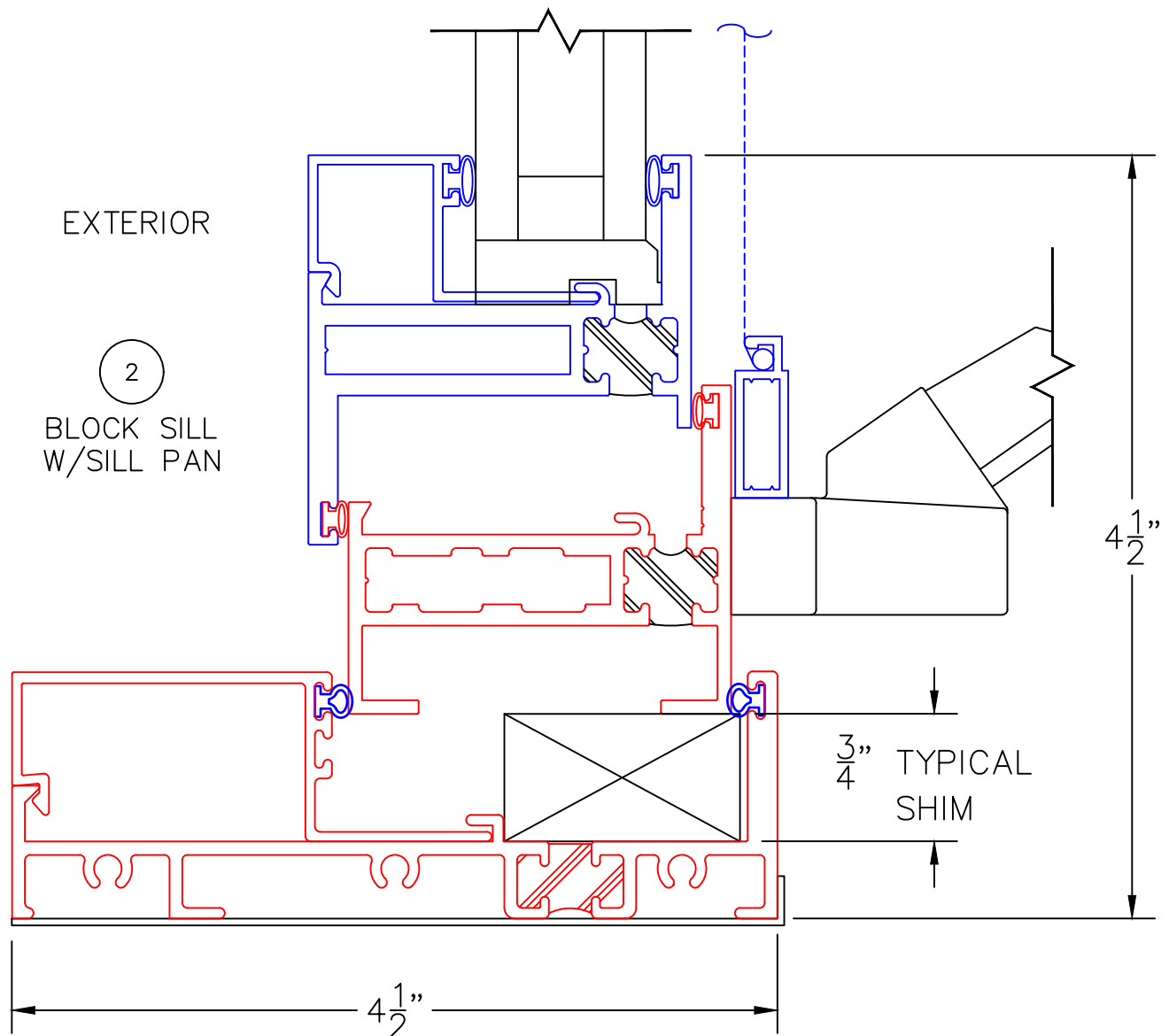

3800-T SILL WITH  
350-T CASEMENT INSERT

0 0.5 1  
(USE RULER TO SCALE DIMENSIONS IN INCHES)  
**SCALE: FULL**

WINDOW INSERT DETAILS  
1" INSULATED GLAZING

3  
HORIZONTAL  
TDL

EXTERIOR

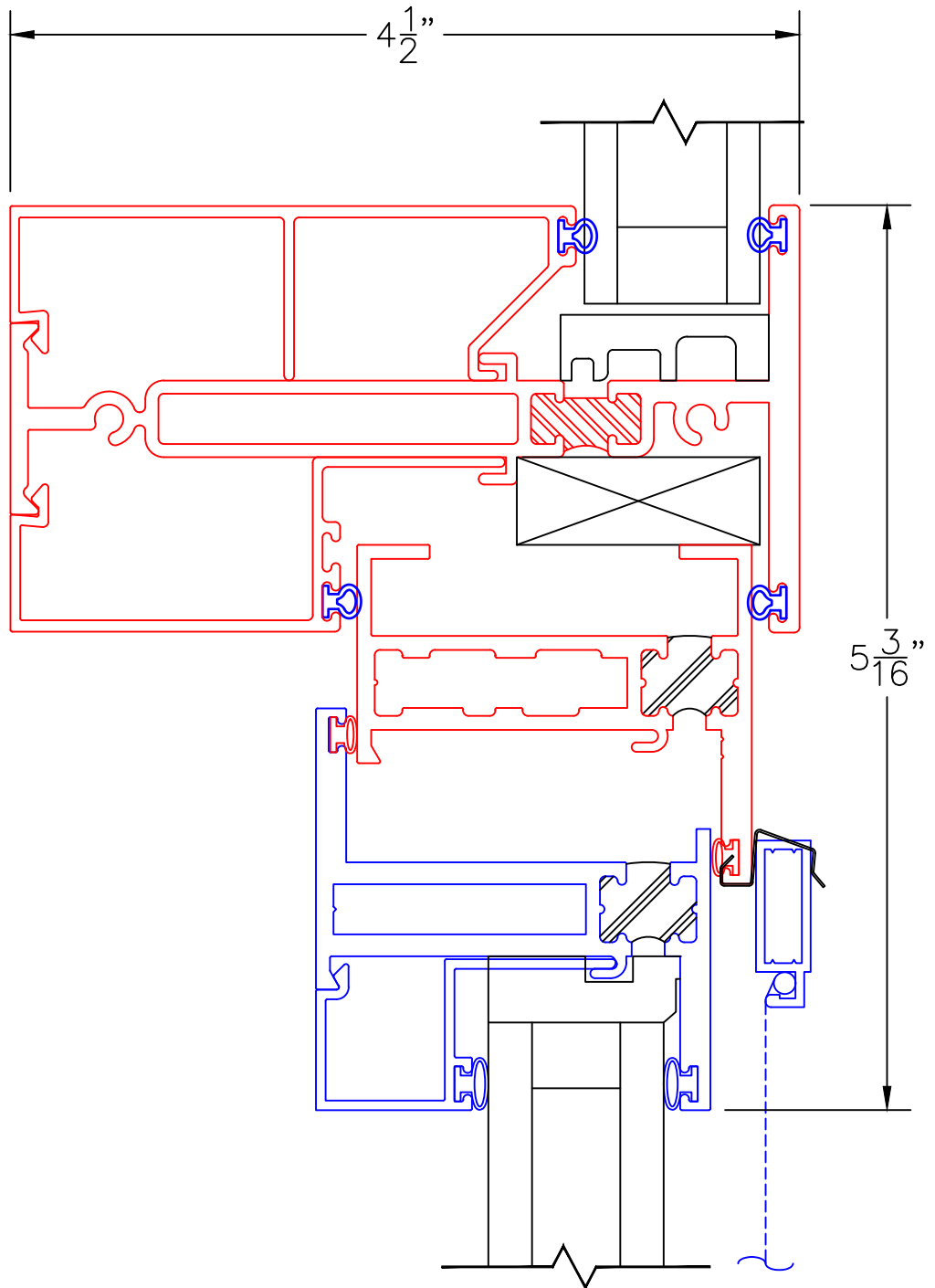

3800-T 1" GLAZING OVER  
350-T AWNING INSERT

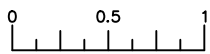

(USE RULER TO SCALE DIMENSIONS IN INCHES)

**SCALE: FULL**

WINDOW INSERT DETAILS  
1" INSULATED GLAZING

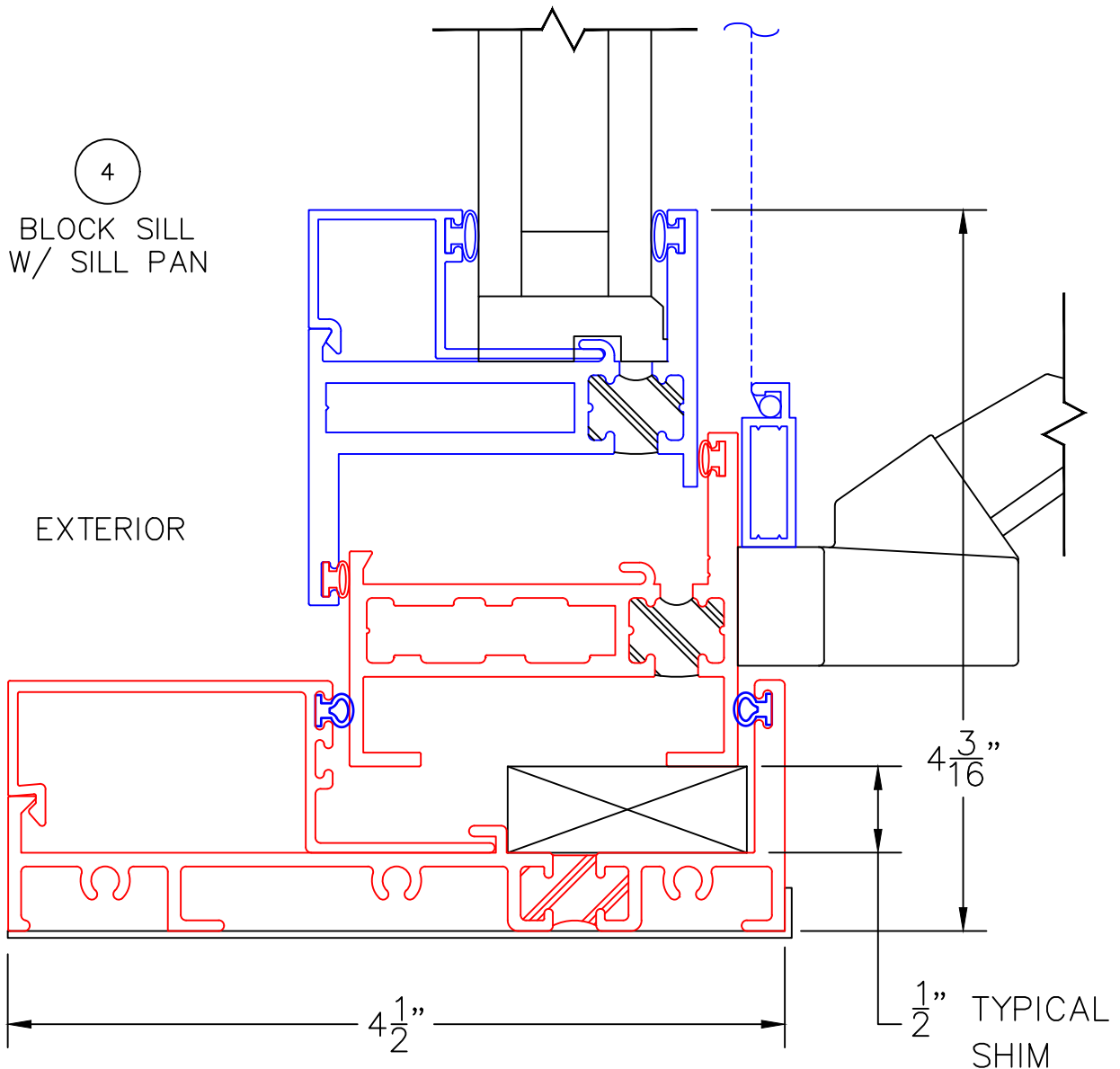

3800-T SILL WITH  
350-T AWNING INSERT

0 0.5 1  
(USE RULER TO SCALE DIMENSIONS IN INCHES)  
**SCALE: FULL**

WINDOW INSERT DETAILS  
GLAZING AS NOTED

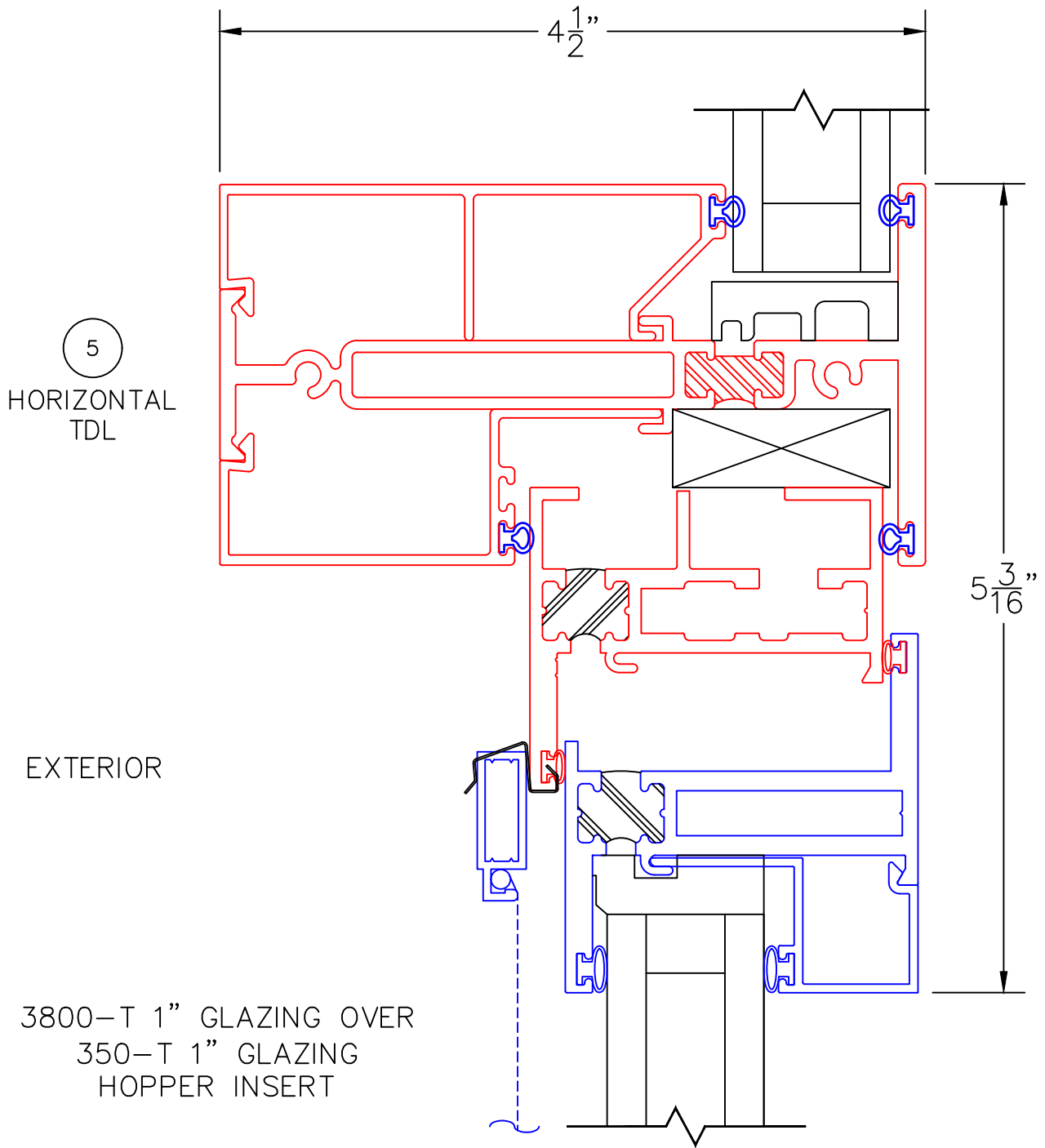

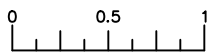

(USE RULER TO SCALE DIMENSIONS IN INCHES)

**SCALE: FULL**

WINDOW INSERT DETAILS  
1" INSULATED GLAZING

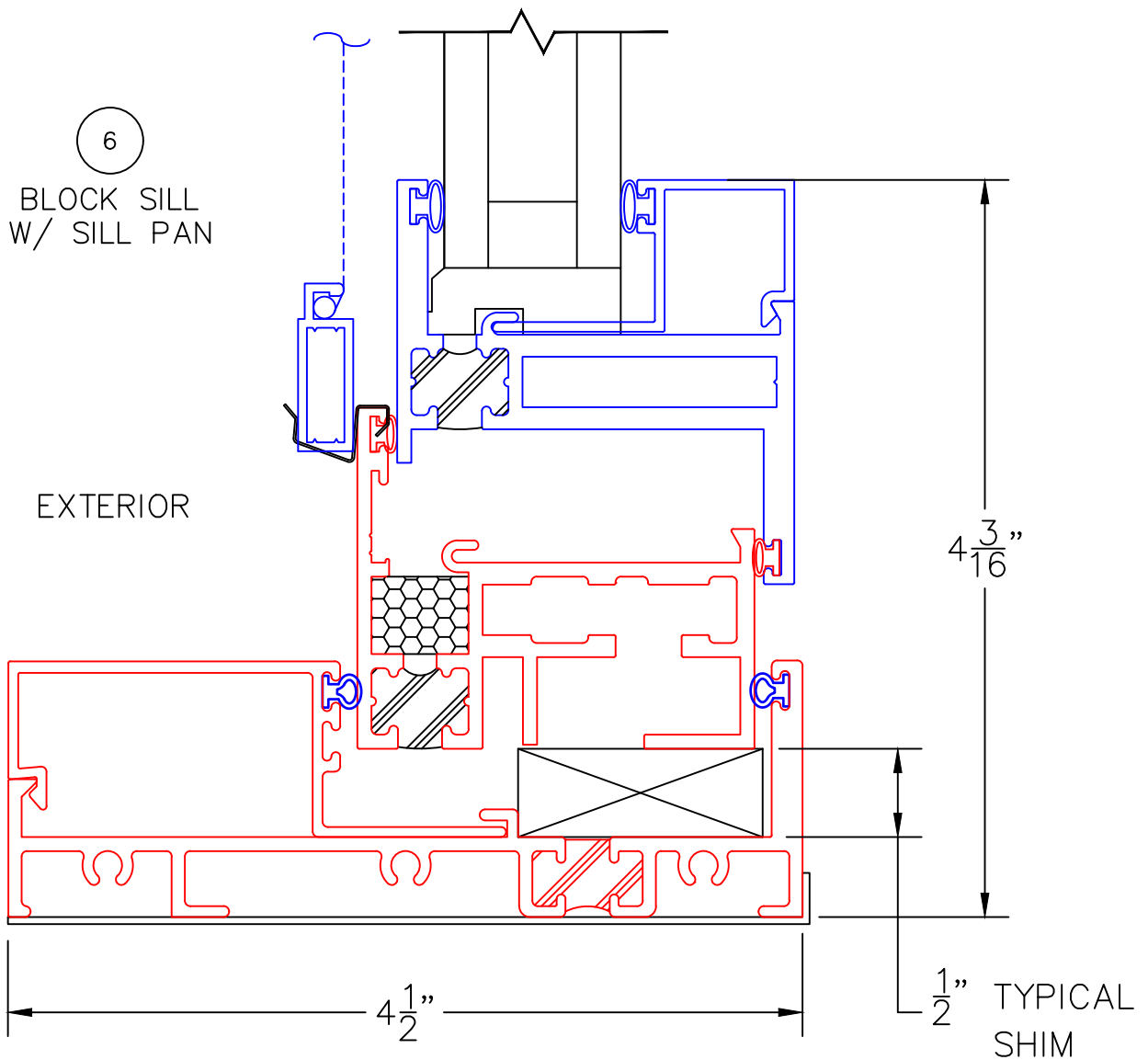

3800-T SILL WITH  
350-T HOPPER INSERT



0 0.5 1  
(USE RULER TO SCALE DIMENSIONS IN INCHES)  
**SCALE: FULL**

WINDOW INSERT DETAILS  
1/4" SINGLE GLAZING

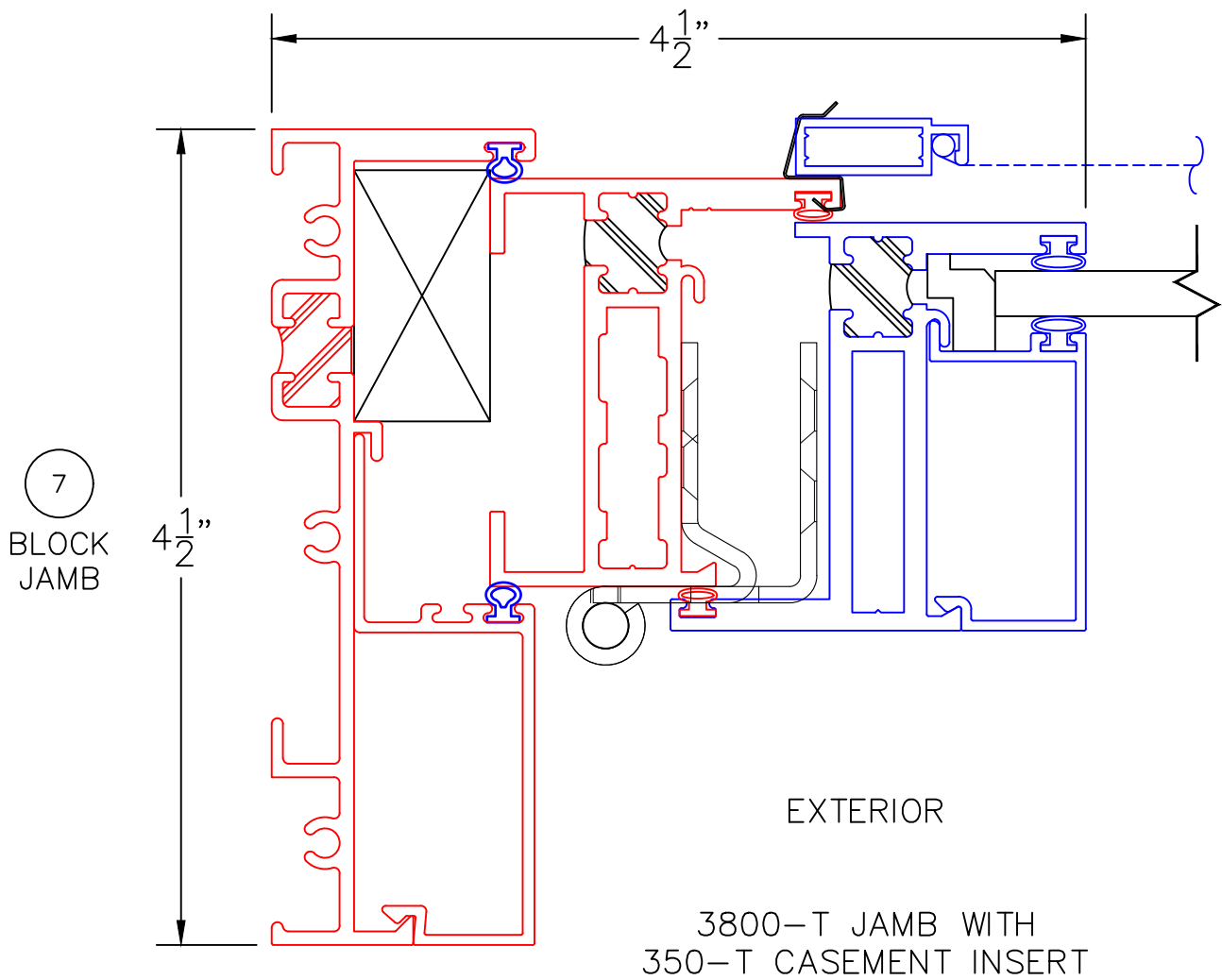

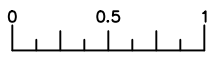

(USE RULER TO SCALE DIMENSIONS IN INCHES)

**SCALE: FULL**

WINDOW INSERT DETAILS  
1" INSULATED GLAZING

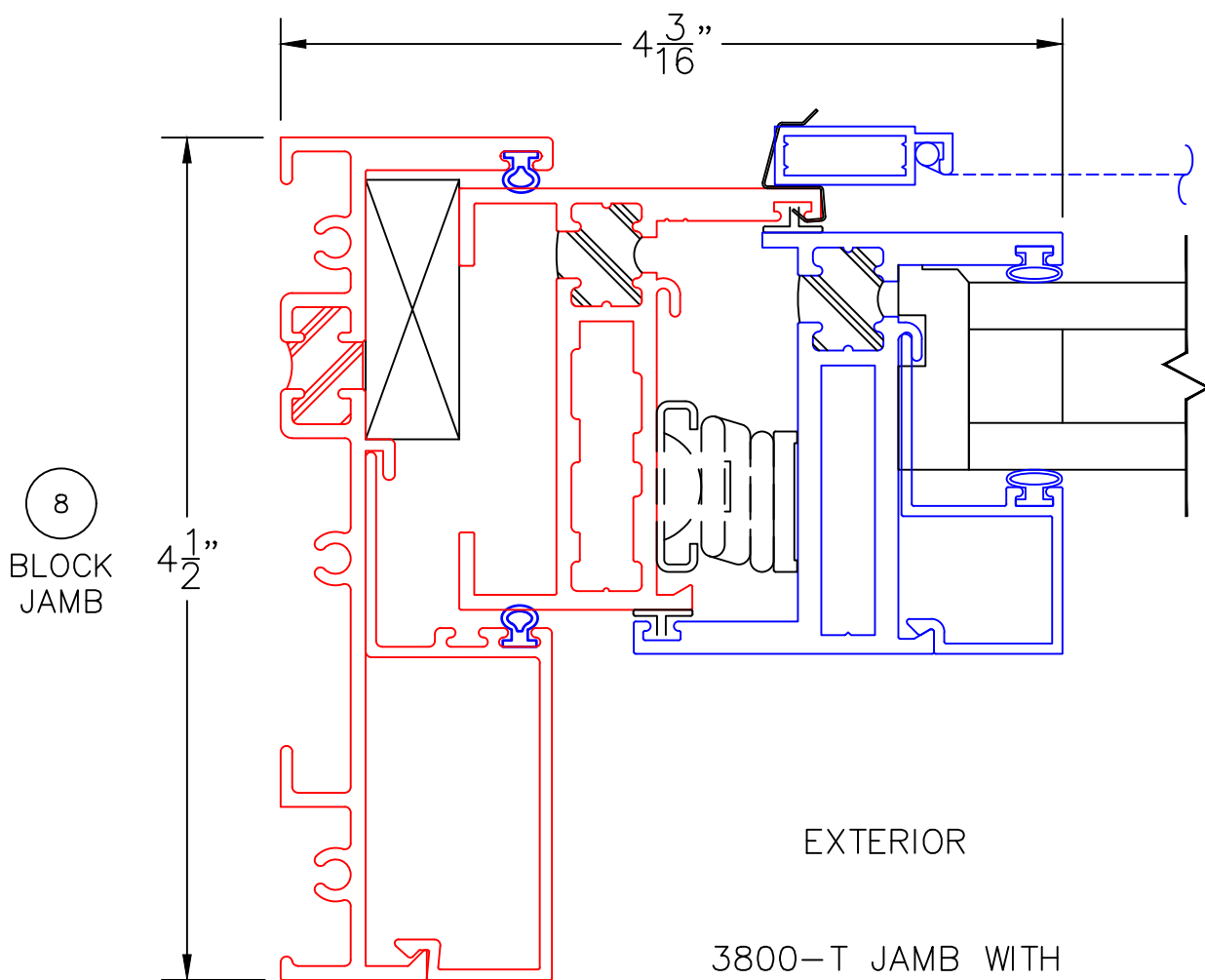

EXTERIOR

3800-T JAMB WITH  
350-T AWNING INSERT





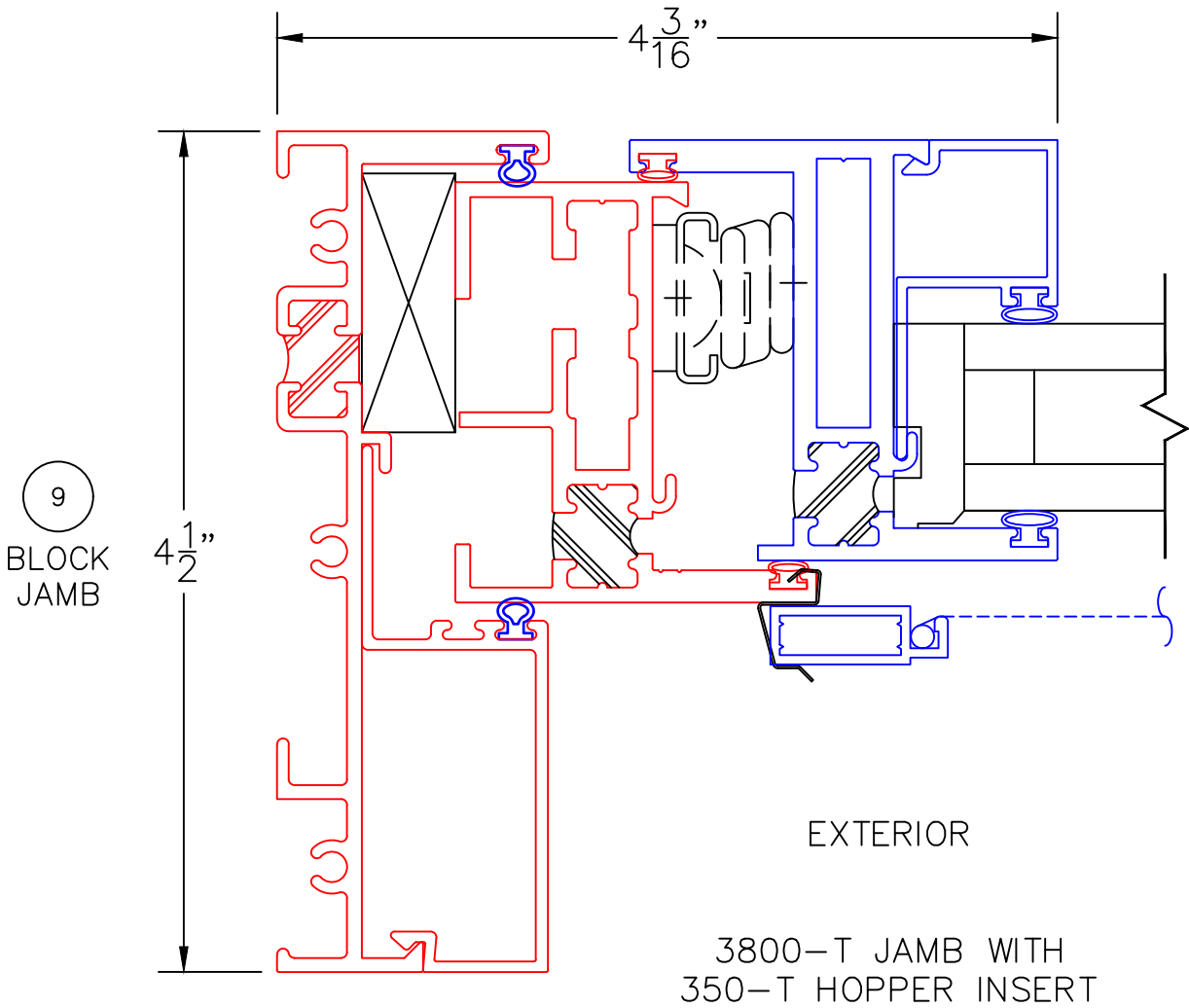









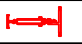

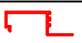

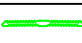

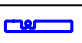
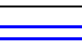

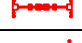

0 0.5 1  
(USE RULER TO SCALE DIMENSIONS IN INCHES)  
**SCALE: FULL**

WINDOW INSERT DETAILS  
1" INSULATED GLAZING

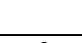

[Architecturals  
Click Here](#)

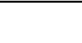
[Product Specs  
Click Here](#)

BILL OF MATERIALS			
ITEM#	PART#	DESCRIPTION	IMAGE
ALUMINUM EXTRUSIONS			
1	3801	1" GLAZING BEAD	
2	<del>3802</del>	<del>1" BENDABLE GLAZING BEAD</del>	<del></del>
3	<del>3803</del>	<del>1/4" GLAZING BEAD</del>	<del></del>
4	3804	9/16" GLAZING BEAD	
5	3805	4.5 FRAME	
6	3806	TDL	
7	3807	1-1/2" SERIES GLASS STOP	
8	3810	2-1/4" SERIES GLASS STOP	
9	3811	1 1/4" GLASS STOP	
10	3812	INTERSECTING MULLION KEY (INTERSECTING TDL)	
11	3814	APPLIED GRID INTERIOR	
12	3815	SHEAR BLOCK (FOR HP ONLY)	
13	FW1194	2.0" x 0.25" ALUMINUM BAR (INTERSECTING TDL HP ONLY)	
14	FW1195	1.5" x 0.25" ALUMINUM BAR (INTERSECTING TDL HP ONLY)	
15		SILL PAN, BLOCK FRAME	
16		SILL PAN, NAIL ON	
17	3082	THERMAL MULLION	
18	3809	4.5 BLOCK FRAME	
19	<del>3816</del>	<del>1 1/4" TIERED GLASS STOP</del>	<del></del>
20	3817	90° CORNER BUTT GLAZED EXTERIOR CAP/COVER FOR 1.25" GLASS	
21	3818	90° CORNER BUTT GLAZED INTERIOR CAP/COVER FOR 1.25" GLASS	
HARDWARE			
31	VARY BY COLOR	SCREW NO 10, PPH, 1.00"	
32	VARY BY COLOR	SCREW NO 6, PFHU, .50"	
33	VARY BY COLOR	SCREW NO 8, PFH, 1 1/2"	
SEAL & SEALANT			
51	25199	BULB VINYL - MINI (ASTM C864)	
52	25031	BULB VINYL - LARGE (ASTM C864)	
53	19120	Q-LON WEATHERSTRIP (U 5212)	
54	18622	SETTING BLOCK 3/8 X 1 X 4	
55	18621	SETTING BLOCK 1/8 X 1 X 4	
56	23217	RIGID PVC SETTING BLOCK	