

ASSEMBLY / PARTS LIST (B.O.M.)

Series: 3070
Type: OXIXO Configuration

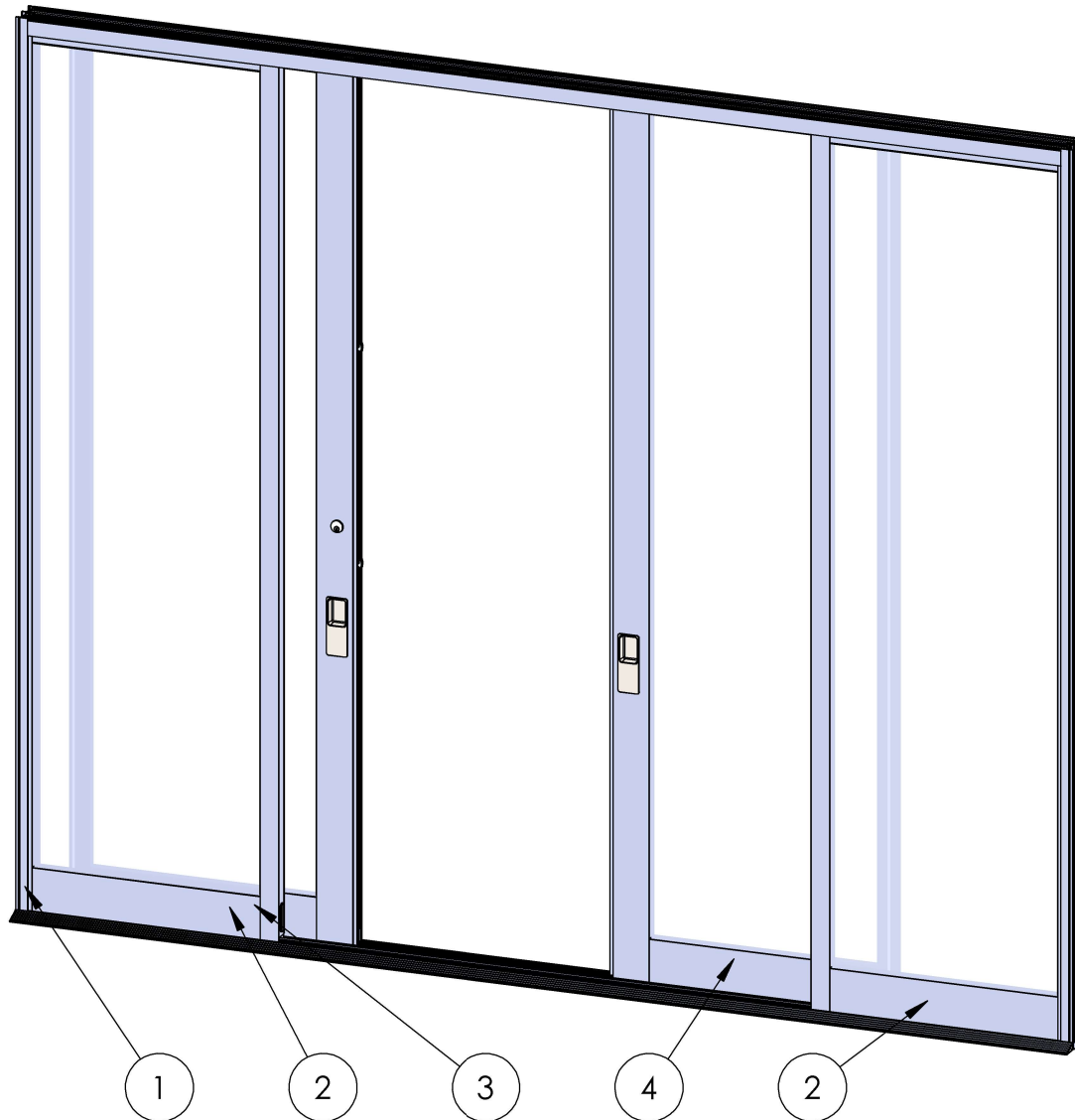

ITEM NO.	DESCRIPTION	PAGE #
1	Frame Assembly	2-3
2	Fixed Panel Assembly	4
3	Sliding Panel Assembly (XI)	5-6
4	Sliding Panel Assembly (IX)	7-8

Description Table of Contents		
File Name Series 3070 OXIXO Without Screen Assembly		REV C
Released	8/17/2023	SHEET 1 OF 8

PROPRIETARY AND CONFIDENTIAL
THE INFORMATION CONTAINED IN THIS DRAWING IS THE SOLE PROPERTY OF FLEETWOOD WINDOWS & DOORS.
ANY REPRODUCTION IN PART OR AS A WHOLE WITHOUT THE WRITTEN PERMISSION OF FLEETWOOD WINDOWS & DOORS IS PROHIBITED.

ASSEMBLY / PARTS LIST (B.O.M.)

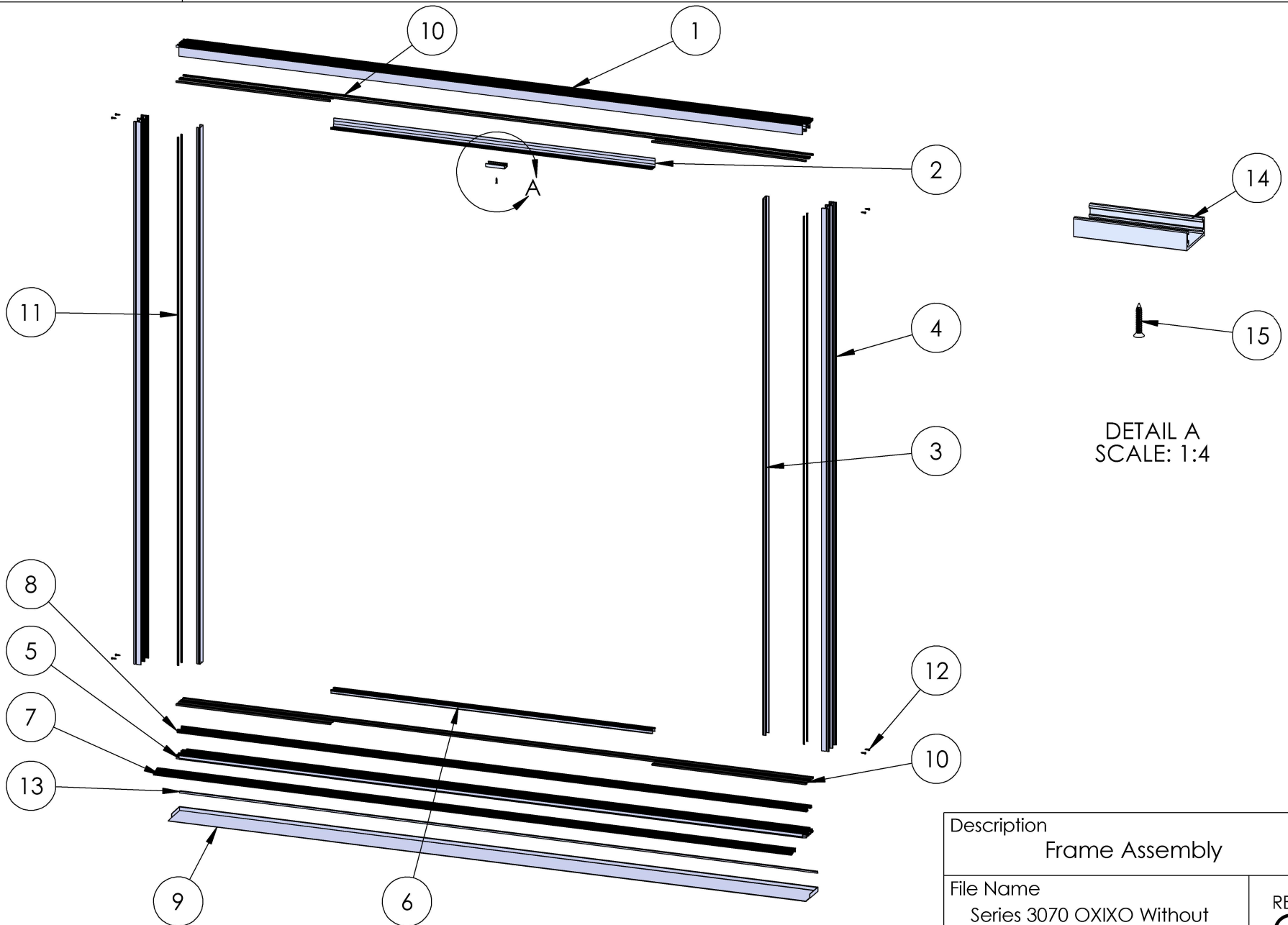

PROPRIETARY AND CONFIDENTIAL
THE INFORMATION CONTAINED IN THIS DRAWING IS THE SOLE PROPERTY OF FLEETWOOD WINDOWS & DOORS.
ANY REPRODUCTION IN PART OR AS A WHOLE WITHOUT THE WRITTEN PERMISSION OF FLEETWOOD WINDOWS & DOORS IS PROHIBITED.

Description Frame Assembly		
File Name Series 3070 OXIXO Without Screen Assembly		REV C
Released	8/17/2023	SHEET 2 OF 8

ASSEMBLY / PARTS LIST (B.O.M.)

EXTRUSIONS

ITEM NO.	PART NUMBER	DESCRIPTION	QTY.
1	3702	Multi-Slide Head (2 Track)	1
2	3014	Head Filler Closer	1
3	3710	Jamb Filler	2
4	3712	Jamb (2 track)	2
5	3742	Multi-Slide Sill (2Track)	1
6	3747	Sill Filler	2
7	3752	Sill Riser (optional)	1
8	FW1020	Stainless Steel Track	2

HARDWARE

ITEM NO.	PART NUMBER	DESCRIPTION	QTY.
9	-	Sill Pan	1
10	19118	Small Fin Seal Mohair	18
11	25757	Q-Lon Foam Seal	4
12	20345	#10 PHP - A, 3/4", Zinc, Clear	8
13	23220	Sill Pan Hem Cover	1
14	24098	Head Anti Lift	1
15	20247	#8, FHP - A Screw, 1 in, SS, Clear	1

Description
Frame Assembly B.O.M.

File Name
Series 3070 OXIXO Without
Screen Assembly

REV
C

PROPRIETARY AND CONFIDENTIAL

THE INFORMATION CONTAINED IN THIS DRAWING IS THE SOLE PROPERTY OF FLEETWOOD WINDOWS & DOORS.
ANY REPRODUCTION IN PART OR AS A WHOLE WITHOUT THE WRITTEN PERMISSION OF FLEETWOOD WINDOWS & DOORS IS PROHIBITED.

Released 8/17/2023

SHEET 3 OF 8

ASSEMBLY / PARTS LIST (B.O.M.)

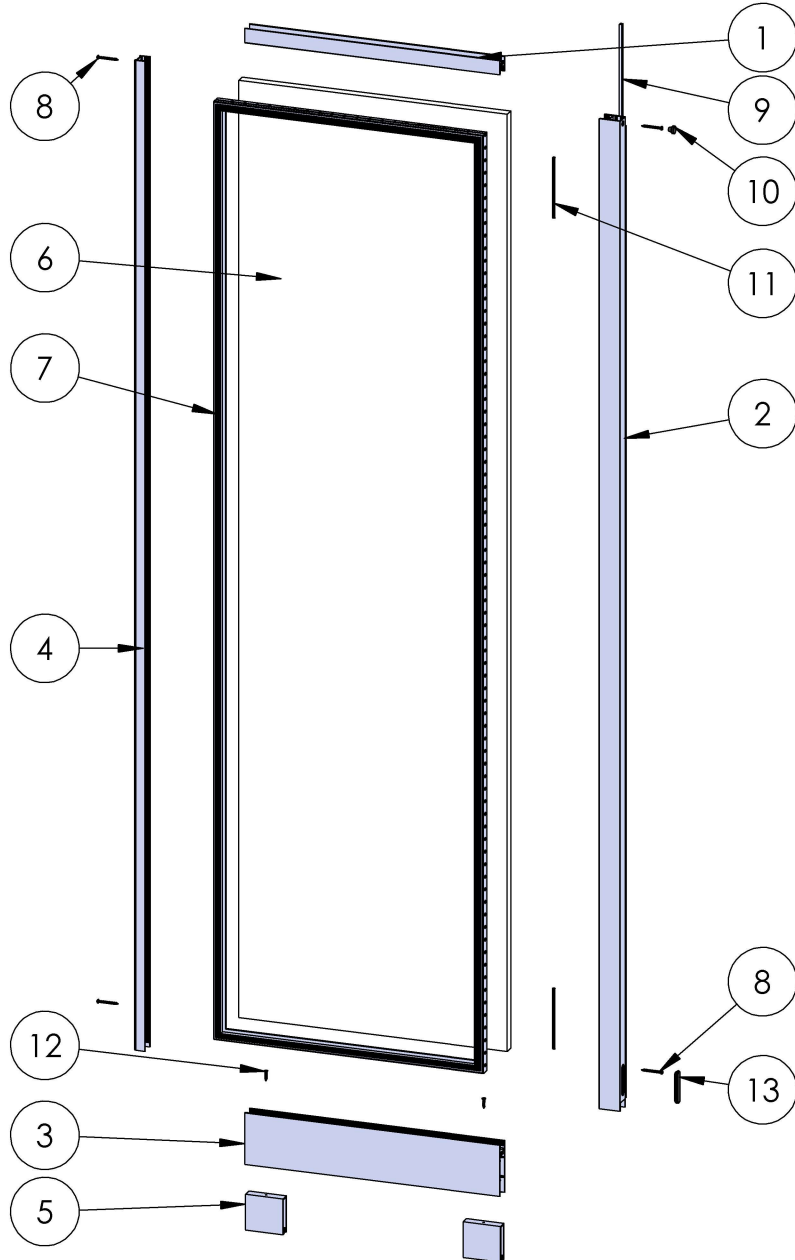

EXTRUSIONS

ITEM NO.	PART NUMBER	DESCRIPTION	QTY.
1	3004	Top Rail	1
2	3006	Interlocker	1
3	3027	Bottom Rail	1
4	3008	Fixed Stile	1

HARDWARE

ITEM NO.	PART NUMBER	DESCRIPTION	QTY.
5	25381	A3 Roller Setting Block	2
6	-	Glass	1
7	22909	1" Glazing Vinyl	1
8	20355	#10 PHP - A, 2", SS, Clear	4
9	19117	Large Fin Seal Mohair	1
10	20635	Small Round Panel Plug	1
11	24672	Screen Spline .230" x 6"	2
12	20293	#10 FHP - A, 1", SS, Clear	2
13	20478	Oval Plug - Long	1

PROPRIETARY AND CONFIDENTIAL

THE INFORMATION CONTAINED IN THIS DRAWING IS THE SOLE PROPERTY OF FLEETWOOD WINDOWS & DOORS.
ANY REPRODUCTION IN PART OR AS A WHOLE WITHOUT THE WRITTEN PERMISSION OF FLEETWOOD WINDOWS & DOORS IS PROHIBITED.

Description Fixed Panel Assembly	
File Name Series 3070 OXIXO Without Screen Assembly	REV C
Released 8/17/2023	SHEET 4 OF 8

ASSEMBLY / PARTS LIST (B.O.M.)

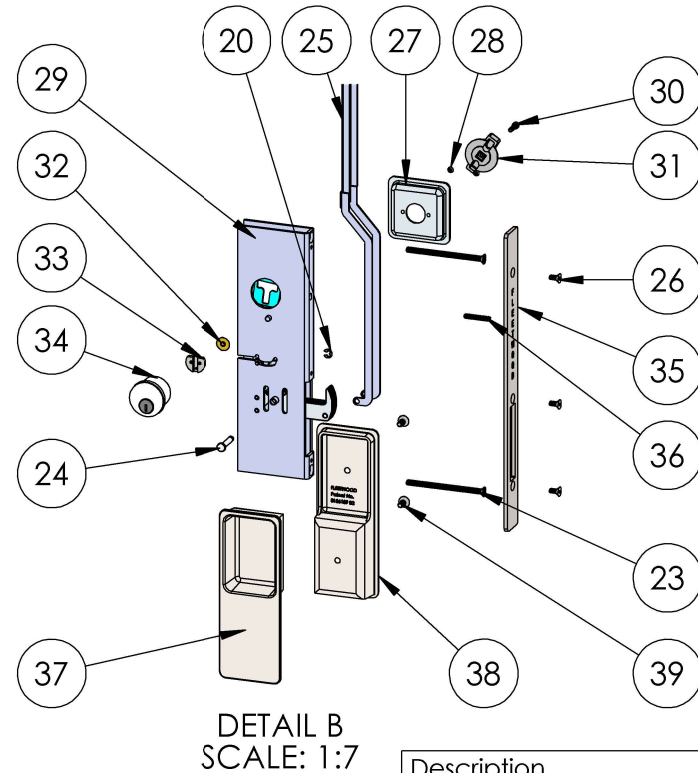
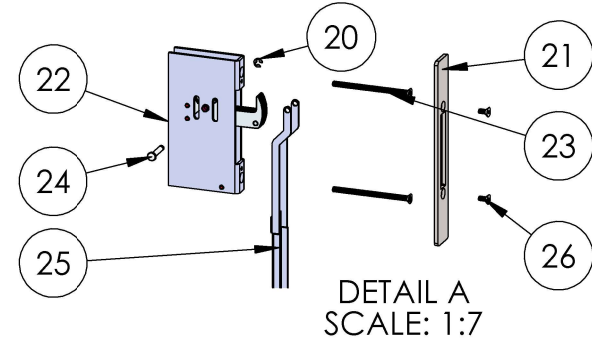
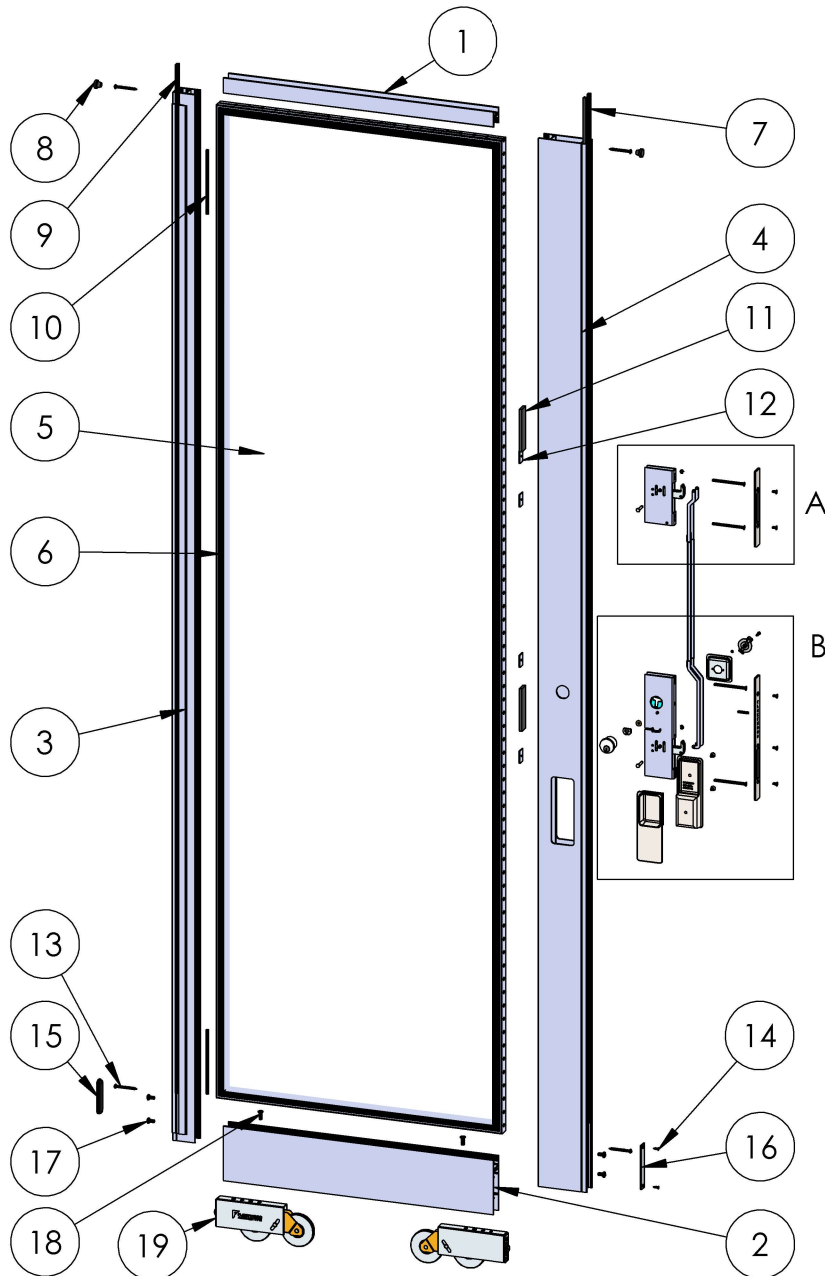

PROPRIETARY AND CONFIDENTIAL
THE INFORMATION CONTAINED IN THIS DRAWING IS THE SOLE PROPERTY OF FLEETWOOD WINDOWS & DOORS.
ANY REPRODUCTION IN PART OR AS A WHOLE WITHOUT THE WRITTEN PERMISSION OF FLEETWOOD WINDOWS & DOORS IS PROHIBITED.

Description Sliding Panel Assembly (XI)	
File Name Series 3070 OXIXO Without Screen Assembly	REV C
Released 8/17/2023	SHEET 5 OF 8

ASSEMBLY / PARTS LIST (B.O.M.)

EXTRUSIONS

ITEM NO.	PART NUMBER	DESCRIPTION	QTY.
1	3004	Top Rail	1
2	3027	Bottom Rail	1
3	3006	Interlocker	1
4	3707	Lock Stile with Female Yoke	1

HARDWARE

5	-	Glass	1
6	22909	1" Glazing Vinyl	1
7	19118	Small Fin Seal Mohair	2
8	20635	Small Round Panel Plug	2
9	19117	Large Fin Seal Mohair	1
10	24672	Screen Spline .230" x 6"	2
11	18620	Setting Block 4" x 1/4" x 1"	2
12	18671	Back Up Plate # 10-32 x 0.075" Thk.	4
13	20355	#10 PHP -A, 2", SS, Clear	4
14	20887	#6 FHP-A-UC Screw, 0.5" (SS)	2
15	20478	Oval Plug - Long	1
16	25035	Meeting Stile Bumper Cover Plate	1
17	20357	#1/4-20 PHP - B, 1/2", SS, Clear	4
18	20305	#1/4-20 FHP - B, 3/4", SS Clear	2
19	18883	A3 Roller	2
20	24129	E-Style Retaining Ring	2
21	26686	Archetype Secondary Latch Faceplate	1
22	24082	Archetype Secondary Latch	1
23	25729	#10-32 FHP, 3", SS, Clear	4
24	24128	Clevis Pin (Archetype Narrow Secondary Latch)	2
25	26373	Archetype Secondary Latch Linkage	1

HARDWARE

ITEM NO.	PART NUMBER	DESCRIPTION	QTY.
26	24076	#8-32 FH Socket Cap Screw, 3/8", SS	5
27	24765, 24080	Archetype Actuator Pocket, OX (SS, BL)	1
28	24074	#4-40 FHP, UC, 1/8", SS, Clear	2
29	24070	Archetype OX Primary Latch	1
30	24072, 24094	#6-32, Hex Socket Head Cap, Self Locking, 1/2", SS (SS, BL)	1
31	24766, 24079	Archetype Actuator (SS, BL)	1
32	24781	Brass Bushing - Key Cylinder Reg. Arch.	1
33	24780	Cam - (for the Archetype Key Cylinder)	1
34	25356, 24782, 24784, 24783	Archetype Keyed Cylinder [SS- (KA, KD), BL- (KA, KD)]	1
35	26685	Archetype Latch Faceplate	1
36	24935	#8-32 Set Screw, 1"	1
37	24090, 24092	Archetype Handle, Outside, w/Gasket (SS, BL)	1
38	24089, 24091	Archetype Handle, Inside, w/Gasket (SS, BL)	1
39	24087, 24093	#10-32 FH Socket Screw, 0.4375" (SS, BL)	2

Description
Sliding Panel Assembly (XI) B.O.M.

File Name
Series 3070 OXIXO Without
Screen Assembly

REV
C

Released 8/17/2023

SHEET 6 OF 8

PROPRIETARY AND CONFIDENTIAL

THE INFORMATION CONTAINED IN THIS DRAWING IS THE SOLE PROPERTY OF FLEETWOOD WINDOWS & DOORS.
ANY REPRODUCTION IN PART OR AS A WHOLE WITHOUT THE WRITTEN PERMISSION OF FLEETWOOD WINDOWS & DOORS IS PROHIBITED.

ASSEMBLY / PARTS LIST (B.O.M.)

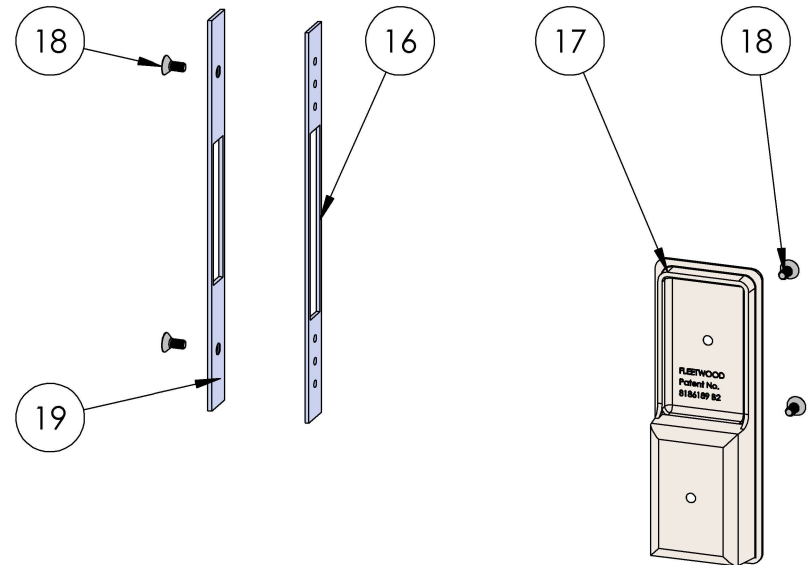
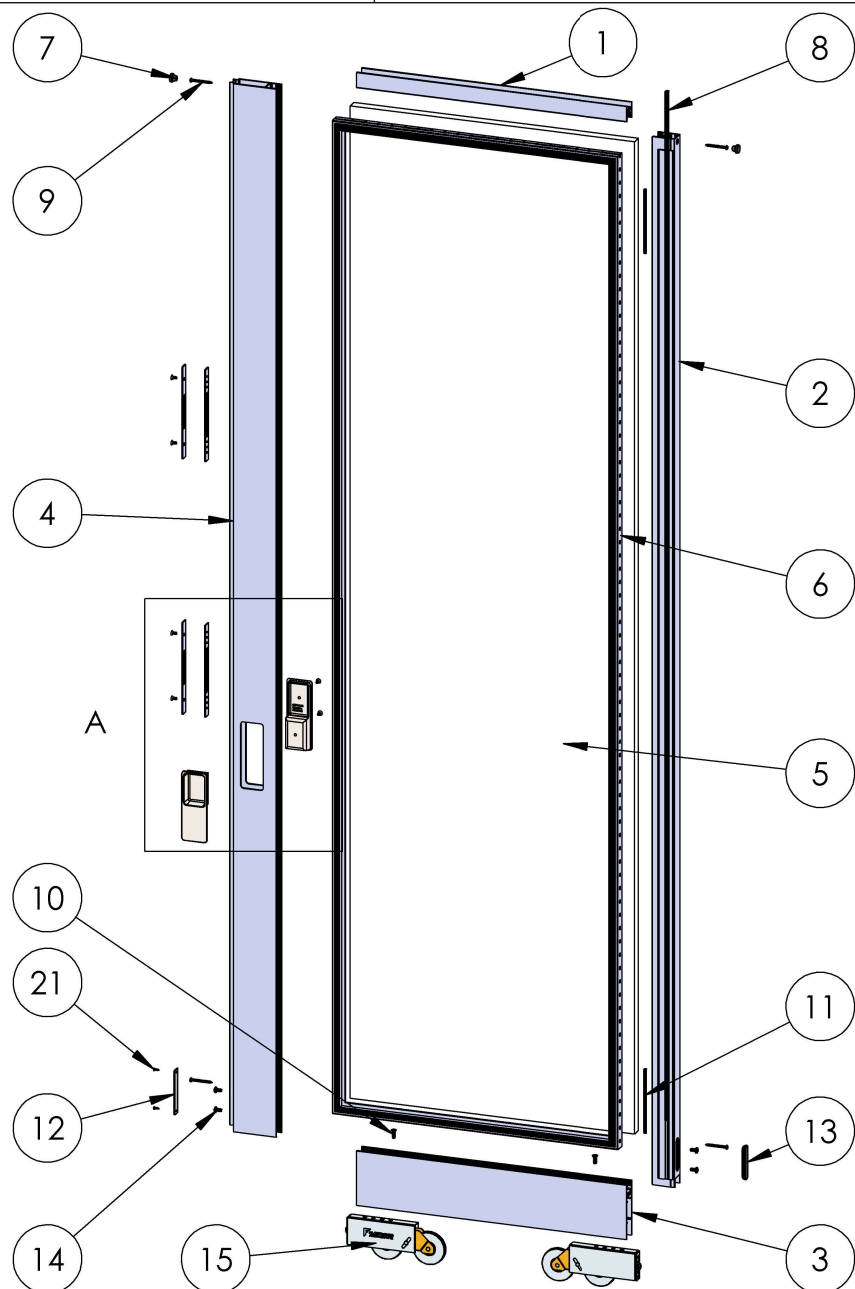

DETAIL A
SCALE: 1:4

PROPRIETARY AND CONFIDENTIAL
THE INFORMATION CONTAINED IN THIS DRAWING IS THE SOLE PROPERTY OF FLEETWOOD WINDOWS & DOORS.
ANY REPRODUCTION IN PART OR AS A WHOLE WITHOUT THE WRITTEN PERMISSION OF FLEETWOOD WINDOWS & DOORS IS PROHIBITED.

Description Sliding Panel Assembly (IX)		
File Name Series 3070 OXIXO Without Screen Assembly		REV C
Released	8/17/2023	SHEET 7 OF 8

ASSEMBLY / PARTS LIST (B.O.M.)

EXTRUSIONS

ITEM NO.	PART NUMBER	DESCRIPTION	QTY.
1	3004	Top Rail	1
2	3006	Interlocker	1
3	3027	Bottom Rail	1
4	3706	Lock Stile with Male Yoke	1

HARDWARE

ITEM NO.	PART NUMBER	DESCRIPTION	QTY.
5	-	Glass	1
6	22909	1" Glazing Vinyl	1
7	20635	Small Round Panel Plug	2
8	19117	Large Fin Seal Mohair	1
9	20355	#10 PHP -A, 2", SS, Clear	4
10	20305	#1/4-20 FHP - B, 3/4", SS Clear	2
11	24672	Screen Spline .230" x 6"	2
12	25035	Meeting Stile Bumper Cover Plate	1
13	20478	Oval Plug - Long	1
14	20357	#1/4-20 PHP - B, 1/2", SS, Clear	4
15	18883	A3 Roller	2
16	24981	Strike Backup Plate, Meeting Stile	2
17	24089, 24091	Archetype Handle, Inside, w/Gasket (SS, BL)	1
18	24087, 24093	#10-32 FH Socket Screw, 0.4375" (SS, BL)	6
19	24980	Strike Plate, Meeting Stile	2
20	24090, 24092	Archetype Handle, Outside, w/Gasket (SS, BL)	1
21	20887	#6 FHP-A-UC Screw, 0.5" (SS)	2

Description
Sliding Panel Assembly (IX) B.O.M.

File Name
Series 3070 OXIXO Without
Screen Assembly

REV
C

PROPRIETARY AND CONFIDENTIAL

THE INFORMATION CONTAINED IN THIS DRAWING IS THE SOLE PROPERTY OF FLEETWOOD WINDOWS & DOORS.
ANY REPRODUCTION IN PART OR AS A WHOLE WITHOUT THE WRITTEN PERMISSION OF FLEETWOOD WINDOWS & DOORS IS PROHIBITED.

Released 8/17/2023

SHEET 8 OF 8