

ASSEMBLY / PARTS LIST (B.O.M.)

SERIES: 3070-T

TYPE: XO WITH SCREEN CONFIGURATION

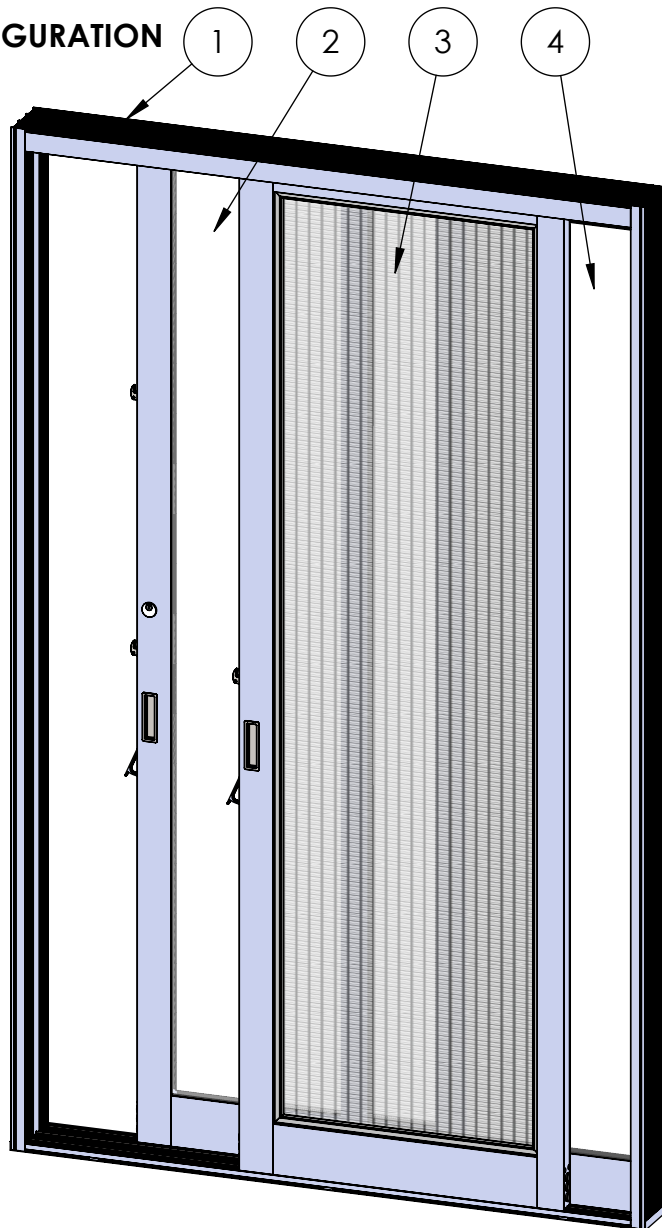

ITEM NO.	DESCRIPTION	PAGE #
1	XO Frame Assembly	2-3
2	X Panel Assembly	4-5
3	Screen Panel Assembly	6-7
4	O Panel Assembly	8
5	Tables	9

NOTES:

1. Secondary Latch only used when net frame height ≥ 96 ".
2. Panels are numbered from left to right as viewed from the exterior.

Description
Table of Contents

File Name
Series 3070-T, XO Narrow
With Screen Assembly

REV

Released 1/19/2021

SHEET 1 OF 9

PROPRIETARY AND CONFIDENTIAL

THE INFORMATION CONTAINED IN THIS DRAWING IS THE SOLE PROPERTY OF FLEETWOOD WINDOWS & DOORS.
ANY REPRODUCTION IN PART OR AS A WHOLE WITHOUT THE WRITTEN PERMISSION OF FLEETWOOD WINDOWS & DOORS IS PROHIBITED.

ASSEMBLY / PARTS LIST (B.O.M.)

NOTES:

1. Frame Assembly scaled down to show detail.

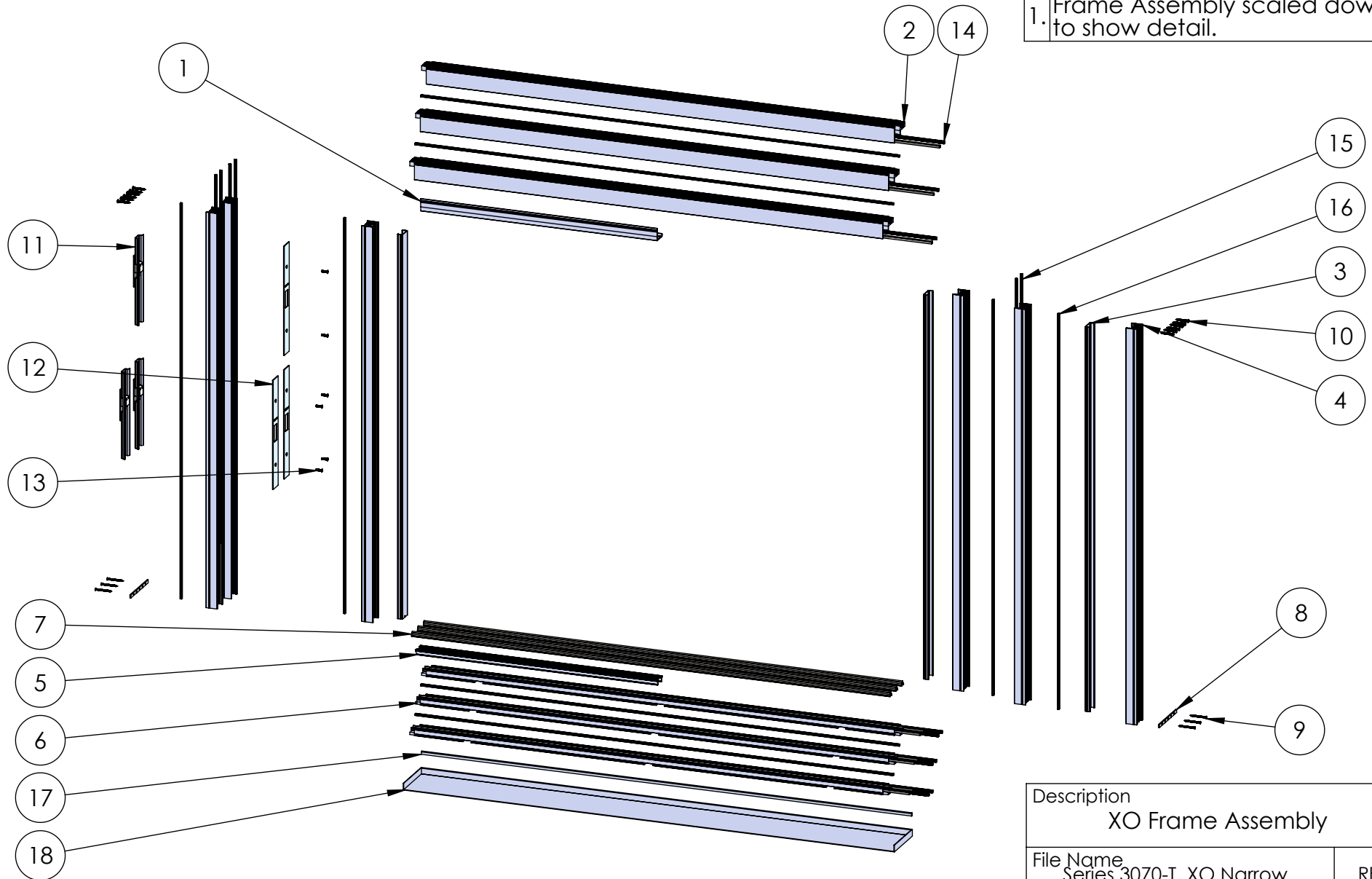

PROPRIETARY AND CONFIDENTIAL

THE INFORMATION CONTAINED IN THIS DRAWING IS THE SOLE PROPERTY OF FLEETWOOD WINDOWS & DOORS.
ANY REPRODUCTION IN PART OR AS A WHOLE WITHOUT THE WRITTEN PERMISSION OF FLEETWOOD WINDOWS & DOORS IS PROHIBITED.

Description
XO Frame Assembly

File Name
Series 3070-T, XO Narrow
With Screen Assembly

REV

Released 1/19/2021

SHEET 2 OF 9

ASSEMBLY / PARTS LIST (B.O.M.)

EXTRUSIONS

ITEM NO.	PART NUMBER	DESCRIPTION	QTY.
1	3014	Head Filler/Closer	1
2	3701	Head 1-Track Assembly	3
3	3710	Jamb Filler	3
4	3711	Jamb 1-Track Assembly	6
5	3747	Sill Filler	2
6	3749	Thermal Sill 1-Track Assembly	3

HARDWARE

ITEM NO.	PART NUMBER	DESCRIPTION	QTY.
7	23006	Stainless Steel Track 9/16"	3
8	25186	Rectangular Washer	6
9	20258	#8 FHP - A, 2 in, SS, Clear	6
10	20353	#10 PHP - A, 1.5 in, SS, Clear	12
11	24790	Backup Plate Assembly	3
12	24067	Strike Plate	3
13	25073	#10-32 FHP - B, .75, SS, Clear	6
14	19118	Small Fin Seal Mohair	18
15	25757	Q-Lon Foam Seal	6
16	23025	PVC MS Track Joiner	8
17	23220	Sillpan Hem Cover	1
18	3720	Sillpan	1

Description
XO Frame B.O.M.

File Name
Series 3070-T, XO Narrow
With Screen Assembly

REV

PROPRIETARY AND CONFIDENTIAL

THE INFORMATION CONTAINED IN THIS DRAWING IS THE SOLE PROPERTY OF FLEETWOOD WINDOWS & DOORS.
ANY REPRODUCTION IN PART OR AS A WHOLE WITHOUT THE WRITTEN PERMISSION OF FLEETWOOD WINDOWS & DOORS IS PROHIBITED.

Released 1/19/2021

SHEET 3 OF 9

ASSEMBLY / PARTS LIST (B.O.M.)

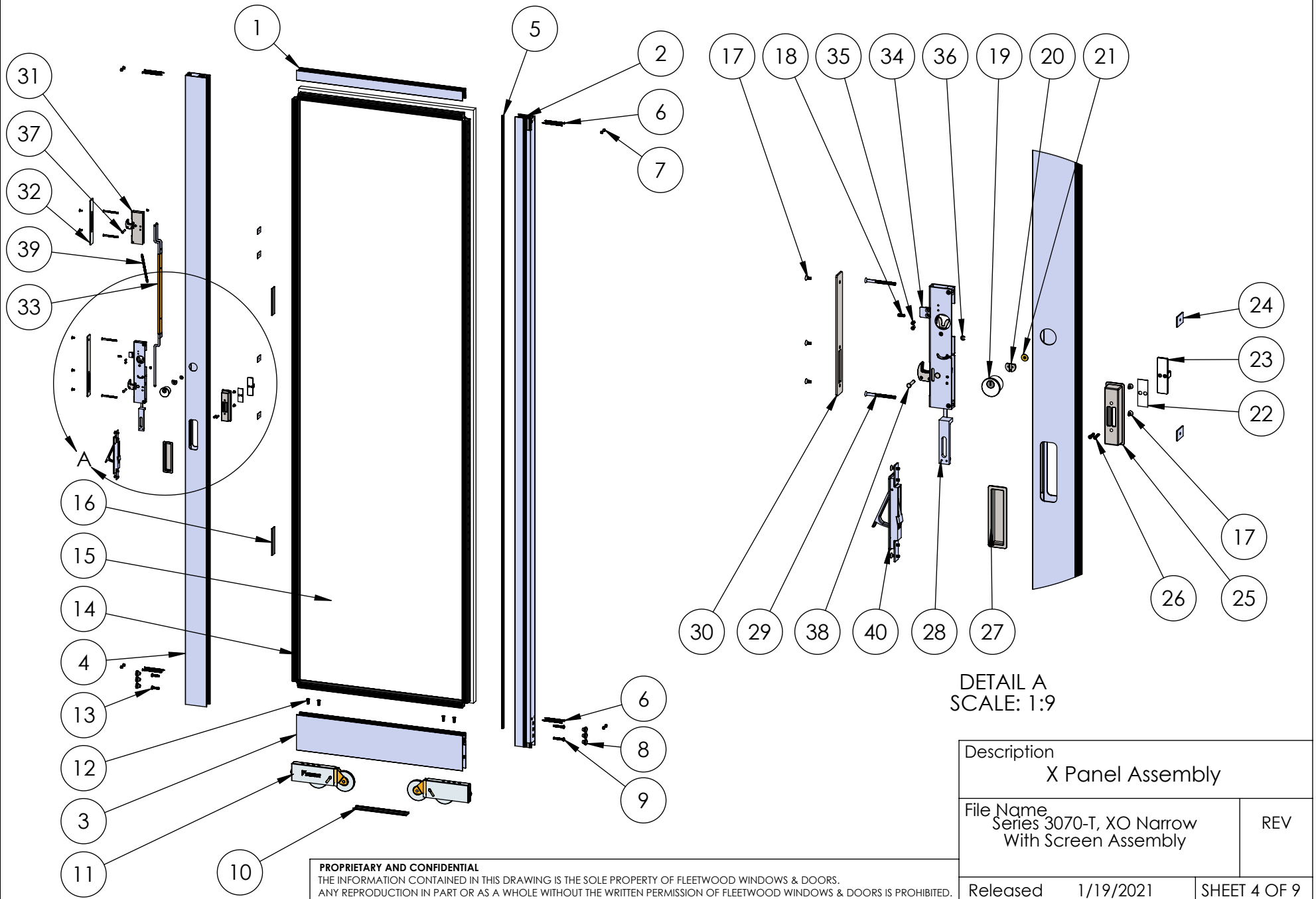

PROPRIETARY AND CONFIDENTIAL
THE INFORMATION CONTAINED IN THIS DRAWING IS THE SOLE PROPERTY OF FLEETWOOD WINDOWS & DOORS.
ANY REPRODUCTION IN PART OR AS A WHOLE WITHOUT THE WRITTEN PERMISSION OF FLEETWOOD WINDOWS & DOORS IS PROHIBITED.

Description X Panel Assembly		
File Name Series 3070-T, XO Narrow With Screen Assembly		REV
Released	1/19/2021	SHEET 4 OF 9

ASSEMBLY / PARTS LIST (B.O.M.)

EXTRUSIONS

ITEM NO.	PART NUMBER	DESCRIPTION	QTY.
1	3075	Thermal Top Rail DG	1
2	3727	Thermal Interlock Sliding Assembly	1
3	3310	Thermal Bottom Rail	1
4	3792	Thermal Narrow Lead Stile (Shear Free Strut)	1

HARDWARE

ITEM NO.	PART NUMBER	DESCRIPTION	QTY.
5	19117	Large Fin Seal Mohair	1
6	20262	#8 FHP Screw, 3 in, SS, Clear	8
7	25907	Round Plug - Plastic - 5/16"	8
8	20635	Small Round Panel Plug (All Doors)	6
9	25724	1/4-20 PHP - B, 1.5 in, SS, Clear	2
10	22938	PVC Rail Spreader, BL798	1
11	18883	A3 Roller, Precision - Tandem	2
12	20305	1/4-20 FHP - B, 3/4 in, SS Clear	4
13	20359	1/4-20 PHP - B, 1 in, SS, Clear	2
14	22909	1 inch Glazing Vinyl (Shown)	1
15	-	Glass	1
16	18621	Setting Block (1/8 in x 4 in)	2
17	24076, 25325	#8-32 FHS, 3/8" Hex Socket Flat (SS, Black)	7
18	25330	#8-32 x 1/2" Set Screw Narrow Arch. Cyl.	1
19	See Table A	Key Cylinder Set	1
20	24780	Cam - (for Archetype Key Cylinder)	1
21	24781	Brass Bushing - Key Cylinder	1

HARDWARE

ITEM NO.	PART NUMBER	DESCRIPTION	QTY.
22	26246	Slider Friction Pad	1
23	25317, 25318	Archetype Narrow Flush Actuator (Black, Stainless Steel)	1
24	18671	Back Up Plate # 10-32 x 0.075 Thk.	4
25	25314, 25315	Archetype Narrow Flush Int. Pocket (Black, Stainless Steel)	1
26	25755	#6-32 FHP with Nylock, .75 in	2
27	25311, 25312	Archetype Narrow Flush Ext. Pocket (Black, Stainless Steel)	1
28	25319	Archetype Narrow Flush Latch XO	1
29	25342	#10-32 PHP Screw, 2.25 in	4
30	25309	Archetype Narrow Latch Face Plate	1
31	26166	Archetype Narrow Secondary Latch	1
32	26225	Archetype Narrow Secondary Latch Faceplate	1
33	26168, 26169	Archetype Narrow Secondary Latch Linkage (OX, XO)	1
34	26170	Archetype Narrow Secondary Latch Linkage Guide	1
35	25890	#6-32 FHP-B Screw, .375 in.	2
36	24129	E-Style Retaining Ring	2
37	24128	Archetype Pin, Clevis Grooved	1
38	26172	Clevis Pin (Primary Archetype Narrow Latch)	1
39	26171	Spring Compensation	1
40	26136	Edge Pull (Thermal Assembly)	1

Description
X Panel Assembly B.O.M.

File Name
Series 3070-T, XO Narrow
With Screen Assembly

REV

PROPRIETARY AND CONFIDENTIAL

THE INFORMATION CONTAINED IN THIS DRAWING IS THE SOLE PROPERTY OF FLEETWOOD WINDOWS & DOORS.
ANY REPRODUCTION IN PART OR AS A WHOLE WITHOUT THE WRITTEN PERMISSION OF FLEETWOOD WINDOWS & DOORS IS PROHIBITED.

Released 1/19/2021

SHEET 5 OF 9

ASSEMBLY / PARTS LIST (B.O.M.)

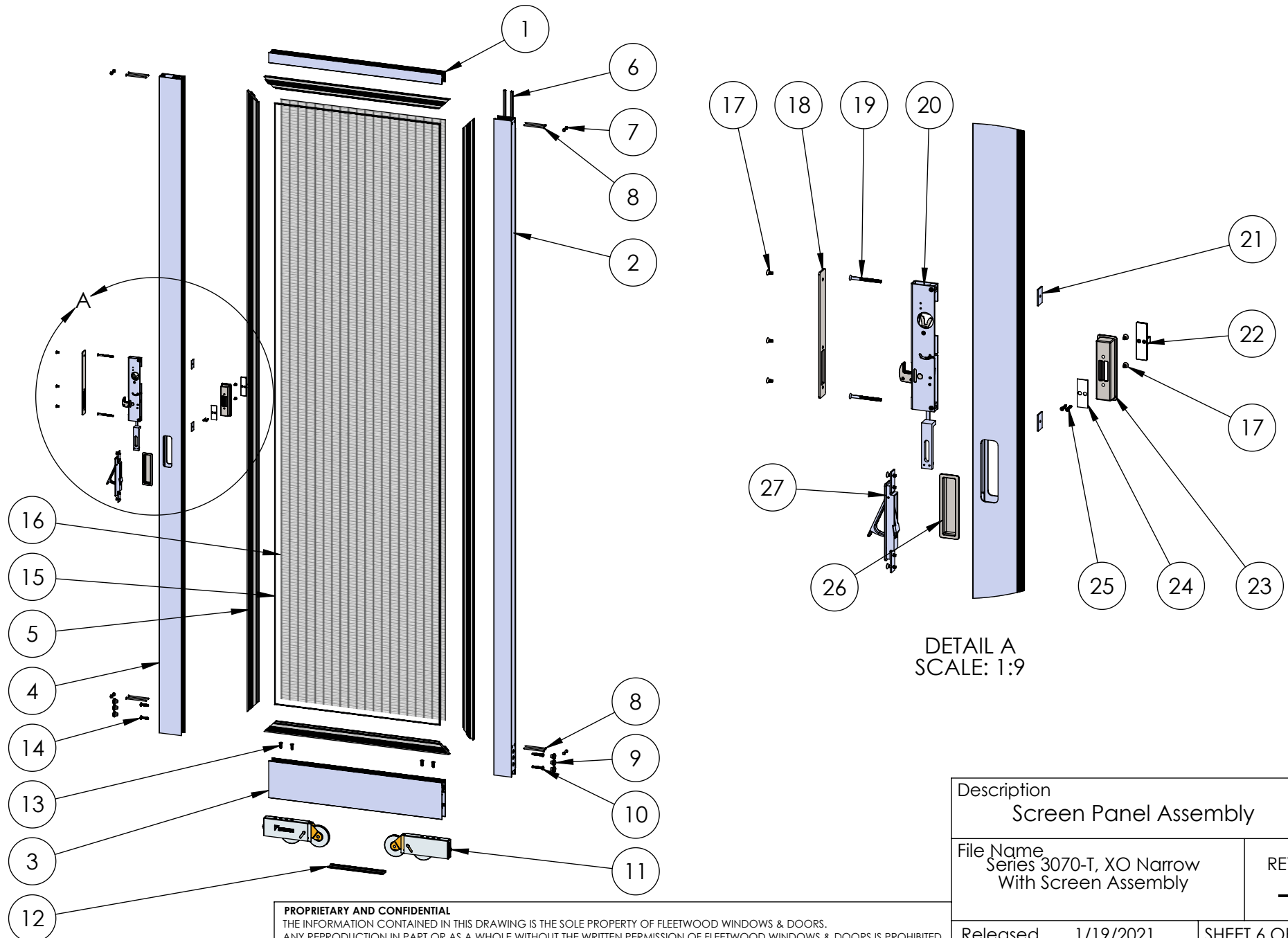

PROPRIETARY AND CONFIDENTIAL

THE INFORMATION CONTAINED IN THIS DRAWING IS THE SOLE PROPERTY OF FLEETWOOD WINDOWS & DOORS.
ANY REPRODUCTION IN PART OR AS A WHOLE WITHOUT THE WRITTEN PERMISSION OF FLEETWOOD WINDOWS & DOORS IS PROHIBITED.

Description Screen Panel Assembly		
File Name Series 3070-T, XO Narrow With Screen Assembly		REV -
Released	1/19/2021	SHEET 6 OF 9

ASSEMBLY / PARTS LIST (B.O.M.)

EXTRUSIONS			
ITEM NO.	PART NUMBER	DESCRIPTION	QTY.
1	3075	Thermal Top Rail DG	1
2	3728	Thermal Interlocker Fixed Assembly	1
3	3310	Thermal Bottom Rail	1
4	3773	Thermal Narrow Lead Stile	1
5	3766	Screen Adapter	4

HARDWARE			
ITEM NO.	PART NUMBER	DESCRIPTION	QTY.
6	19117	Large Fin Seal Mohair	2
7	25907	Round Plug - Plastic - 5/16"	8
8	20262	#8 FHP Screw, 3 in, SS, Clear	8
9	20635	Small Round Panel Plug (All Doors)	6
10	25724	1/4-20 PHP - B, 1.5 in, SS, Clear	2
11	18883	A3 Roller, Precision - Tandem	2
12	22938	PVC Rail Spreader, BL798	1
13	20305	1/4-20 FHP - B, 3/4 in, SS Clear	4
14	20359	1/4-20 PHP - B, 1 in, SS, Clear	2
15	19129	Screen Rubber Spline 0.180 in	1
16	-	Screen Mesh	1
17	24076, 25325	#8-32 FHS, 3/8" Hex Socket Flat (SS, Black)	5

HARDWARE			
ITEM NO.	PART NUMBER	DESCRIPTION	QTY.
18	25309	Archetype Narrow Latch Face Plate	1
19	25342	#10-32 PHP Screw, 2.25 in	2
20	25319	Archetype Narrow Flush Latch XO	1
21	18671	Back Up Plate # 10-32 x 0.075 Thk.	2
22	25317, 25318	Archetype Narrow Flush Actuator (Black, Stainless Steel)	1
23	25314, 25315	Archetype Narrow Flush Int. Pocket (Black, Stainless Steel)	1
24	26246	Slider Friction Pad	1
25	25755	#6-32 FHP with Nylock, .75 in	2
26	25311, 25312	Archetype Narrow Flush Ext. Pocket (Black, Stainless Steel)	1
27	26136	Edge Pull (Thermal Assembly)	1

Description
Screen Panel Assembly B.O.M.

File Name
Series 3070-T, XO Narrow
With Screen Assembly

REV
-

PROPRIETARY AND CONFIDENTIAL

THE INFORMATION CONTAINED IN THIS DRAWING IS THE SOLE PROPERTY OF FLEETWOOD WINDOWS & DOORS.
ANY REPRODUCTION IN PART OR AS A WHOLE WITHOUT THE WRITTEN PERMISSION OF FLEETWOOD WINDOWS & DOORS IS PROHIBITED.

Released 1/19/2021

SHEET 7 OF 9

ASSEMBLY / PARTS LIST (B.O.M.)

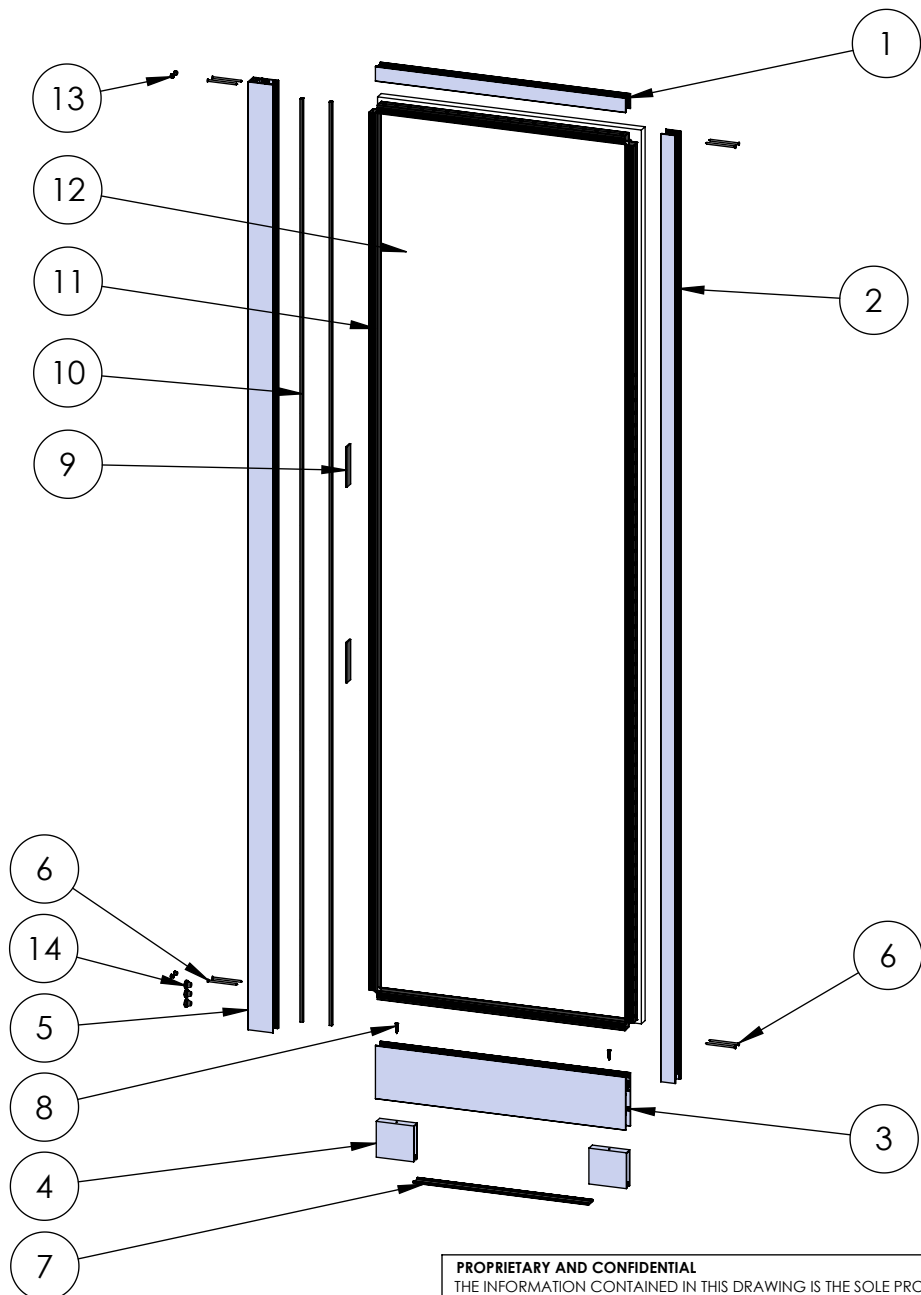

EXTRUSIONS

ITEM NO.	PART NUMBER	DESCRIPTION	QTY.
1	3075	Thermal Top Rail DG	1
2	3073	Fixed Stile DG	1
3	3310	Thermal Bottom Rail	1
4	3762	Setting Block - Mammoth Rail, Fixed Panel	2
5	3728	Thermal Interlocker Fixed Assembly	1

HARDWARE

ITEM NO.	PART NUMBER	DESCRIPTION	QTY.
6	20262	#8 FHP Screw, 3 in, SS, Clear	8
7	22938	PVC Rail Spreader, BL798	1
8	20293	#10 FHP-A, 1", SS, Clear	2
9	18621	Setting Block (1/8 in x 4 in)	2
10	19117	Large Fin Seal Mohair	2
11	22909	1 inch Glazing Vinyl (Shown)	1
12	-	Glass	1
13	25907	Round Plug - Plastic - 5/16"	4
14	20635	Small Round Panel Plug (All Doors)	3

Description
O Panel Assembly

File Name
Series 3070-T, XO Narrow
With Screen Assembly

REV

Released 1/19/2021

SHEET 8 OF 9

PROPRIETARY AND CONFIDENTIAL

THE INFORMATION CONTAINED IN THIS DRAWING IS THE SOLE PROPERTY OF FLEETWOOD WINDOWS & DOORS.
ANY REPRODUCTION IN PART OR AS A WHOLE WITHOUT THE WRITTEN PERMISSION OF FLEETWOOD WINDOWS & DOORS IS PROHIBITED.

ASSEMBLY / PARTS LIST (B.O.M.)

TABLE A: Key Cylinder Options		
Keyed	Color	ID
Alike	Stainless	25356
	Black	24784
Different	Stainless	24782
	Black	24783

PROPRIETARY AND CONFIDENTIAL

THE INFORMATION CONTAINED IN THIS DRAWING IS THE SOLE PROPERTY OF FLEETWOOD WINDOWS & DOORS.
ANY REPRODUCTION IN PART OR AS A WHOLE WITHOUT THE WRITTEN PERMISSION OF FLEETWOOD WINDOWS & DOORS IS PROHIBITED.

Description		
Tables		
File Name Series 3070-T, XO Narrow With Screen Assembly		REV
Released	1/19/2021	SHEET 9 OF 9