

FRAME ANCHOR CHECKLIST	
FASTENER TYPE	
MINIMUM EMBEDMENT	
MINIMUM EDGE DISTANCE	
ANCHOR LOCATIONS	
FROM ENDS	
ON CENTER	

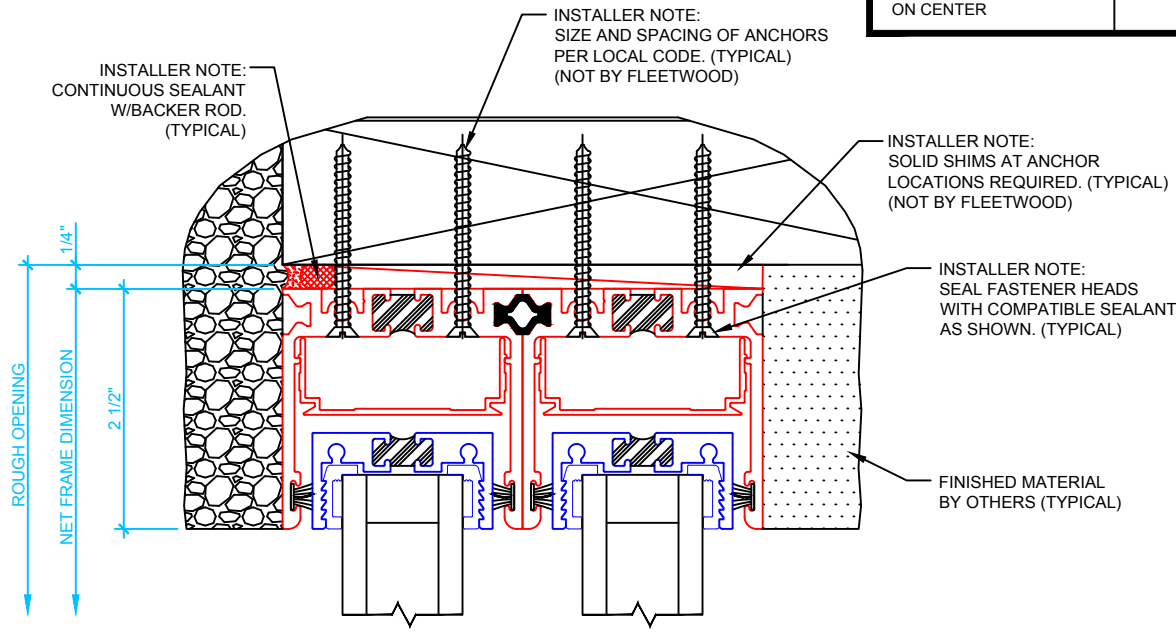

EXTERIOR

1 DOOR HEAD
SCALE: 6" = 1'

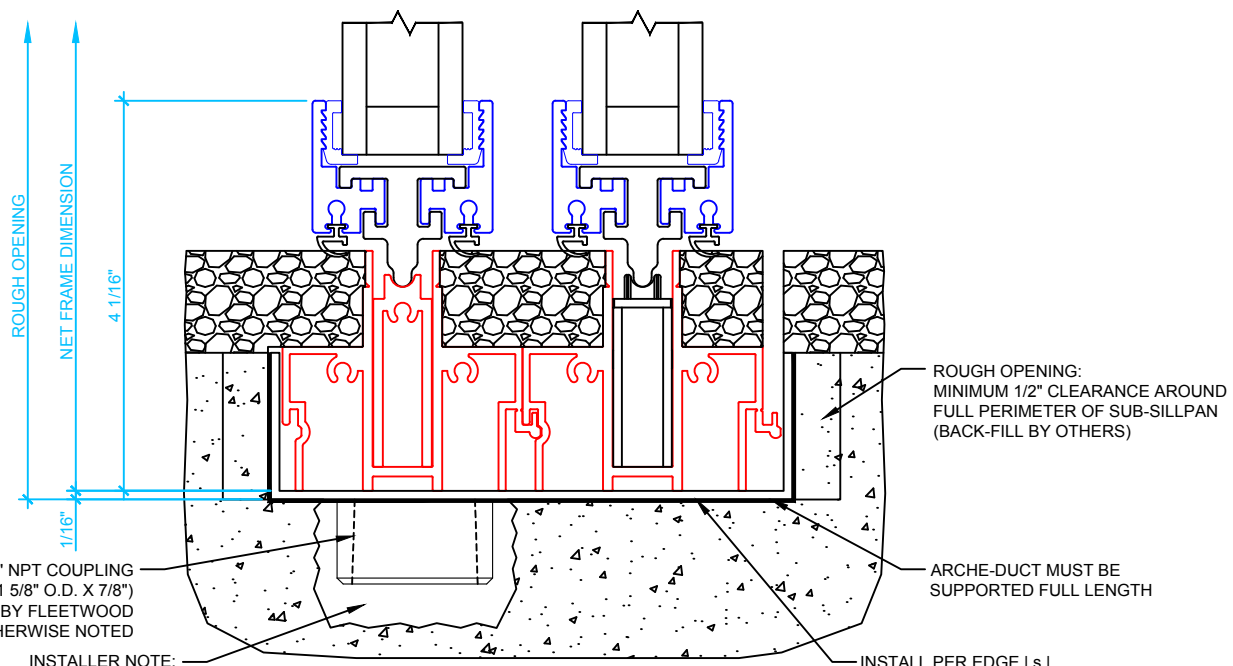

1" NPT COUPLING
(1 5/8" O.D. X 7/8")
WELDED BY FLEETWOOD
UNLESS OTHERWISE NOTED

INSTALLER NOTE:
MINIMUM 2" CHANNEL
AT DRAIN LOCATIONS

ROUGH OPENING:
MINIMUM 1/2" CLEARANCE AROUND
FULL PERIMETER OF SUB-SILLPAN
(BACK-FILL BY OTHERS)

ARCHE-DUCT MUST BE
SUPPORTED FULL LENGTH

INSTALL PER EDGE | s |
INSTALLATION INSTRUCTIONS

2 DOOR SILL
SCALE: 6" = 1'

NOTES: 1. NET FRAME HEIGHT DOES NOT INCLUDE ARCHE-DUCT (.090 MATERIAL).
2. **SILL DISCLAIMER:** IT IS THE MANUFACTURERS DESIRE FOR THE INSTALLER TO **NOT** PIERCE THE SILL. IN SOME CASES THE CODE OR SPECIFICATIONS REQUIRE SUCH. IN THESE CASES THE INSTALLER IS RESPONSIBLE TO SEAL THESE BREACHES.

FRAME ANCHOR CHECKLIST	
FASTENER TYPE	
MINIMUM EMBEDMENT	
MINIMUM EDGE DISTANCE	
ANCHOR LOCATIONS	
FROM ENDS	
ON CENTER	

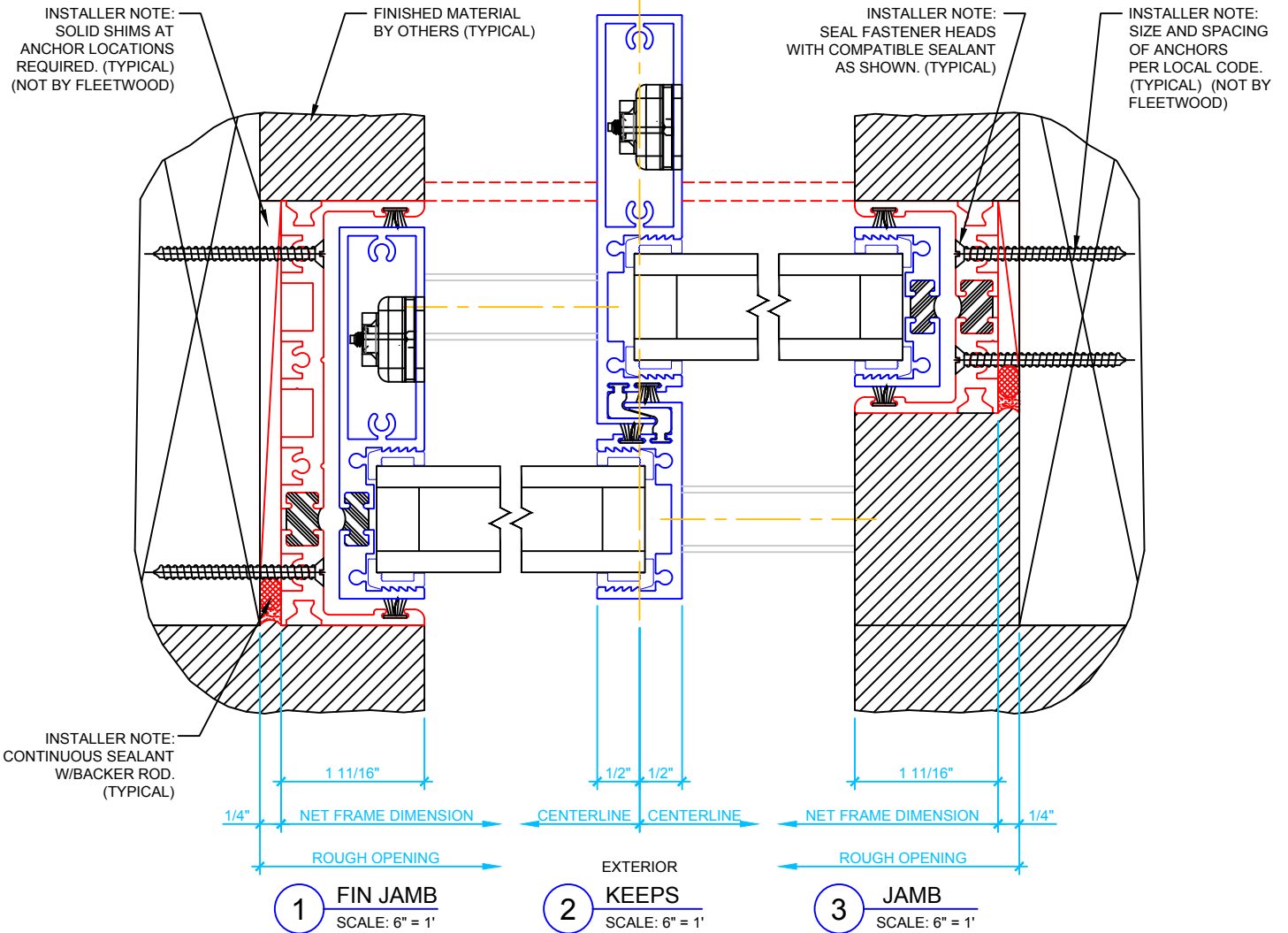

NOTES: 1. NET FRAME WIDTH DOES NOT INCLUDE ARCH-DUCT.