

# FLEETWOOD WINDOWS & DOORS

## INSTALLATION/ASSEMBLY SERIES 530-T

### PANELIZED / FIXED PANEL INSERTION INSTRUCTIONS

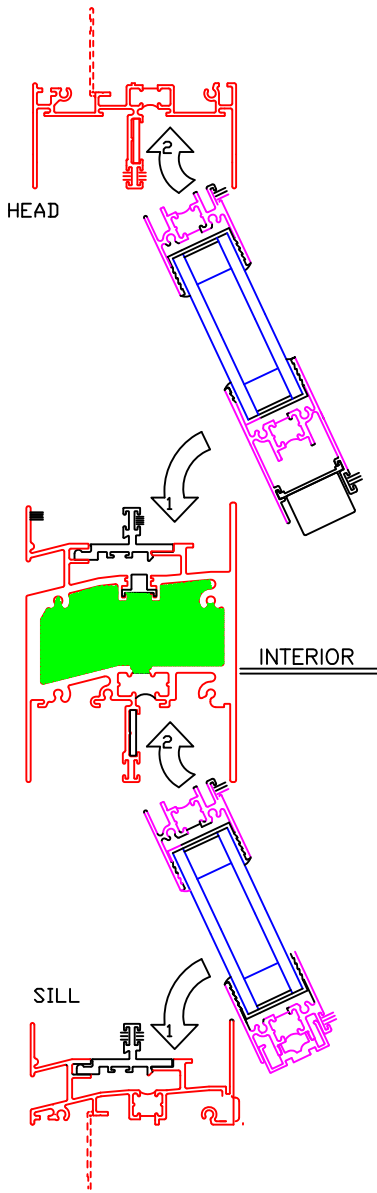

1. FROM THE INSIDE OF THE FRAME, INSERT BOTH OF THE "D" PANELS INTO THE INSIDE CHANNEL OF THE HEAD, PUSH THE PANEL UP INTO THE HEAD AND SWING THE BOTTOM OF THE PANEL IN AND DOWN INTO THE INSIDE CHANNEL OF THE SILL, AS SHOWN.

2. CENTER BOTH OF THE "D" PANEL'S BETWEEN THE MULLION AND THE FIXED JAMB.

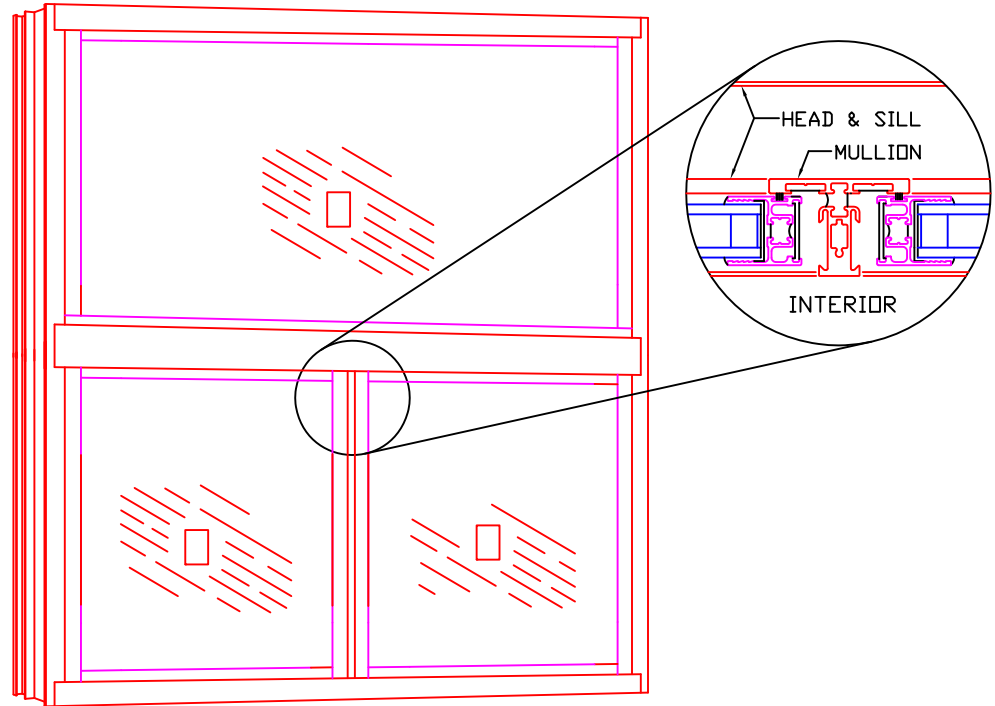

1. SECURE THE FIXED PANELS IN THE FIXED JAMBS BY INSERTING THE FIXED JAMB SNAP-IN'S INTO THE FIXED JAMB, FROM THE INSIDE OF THE FRAME, AS SHOWN.

2. SECURE THE FIXED PANELS AT THE "DD" MULLION BY INSERTING THE "DD" MULLION SNAP-INS INTO THE "DD" MULLION, FROM THE INSIDE OF THE FRAME, AS SHOWN.

