

ASSEMBLY / PARTS LIST (B.O.M.)

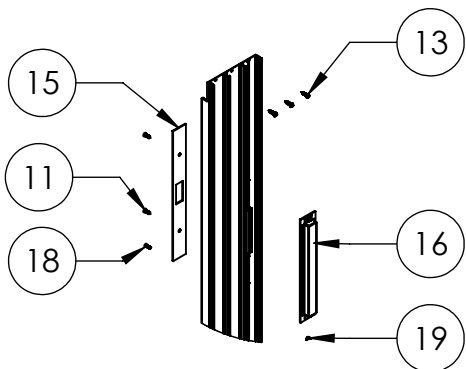
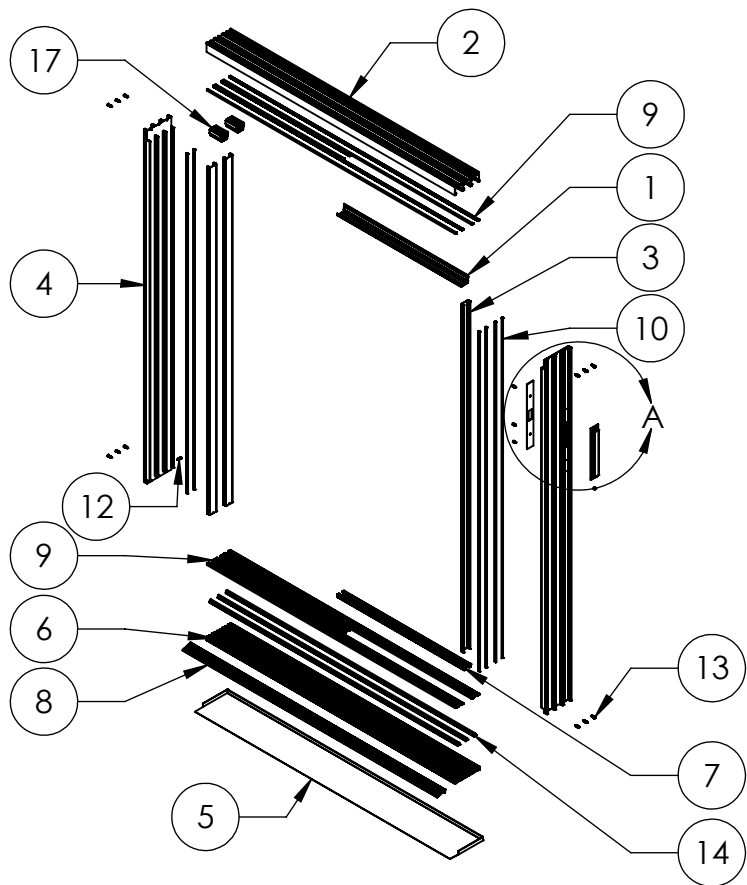

DETAIL A

ITEM NO.	PART NUMBER	DESCRIPTION	QTY.
1	3014	Head Filler / Closer	1
2	3703	Multi-Slide Head (3 Track)	1
3	3710	Jamb Filler	3
4	3713	Multi-Slide Jamb (3 Track)	2
5	3720	Sill Pan	1
6	3743	Multi-Slide Sill (3 Track)	1
7	3747	Sill Filler	2
8	3752	Multislide Sill Riser (exterior)	1
9	19118	Weather Strip 23027045BKQB	18
10	19120	Q-Lon (U5212)	6
11	20278	#10-32 FHP-B-UC, 9/16", SS clear	2
12	20312	#8 PHP - TEK, 3/4", SS, Clear	1
13	20345	#10 PHP - A, 3/4", Zinc, Clear	12
14	23006	Stainless steel Track - 9/16"	3
15	24067	Strike Plate	1
16	24069	Dust Cover	1
17	24101	Bumper, Sliding Door Head Installation 2.625"	2
18	25497	#8-32 FHP,UC, 1/2",SS	1
19	25498	#8-32 Nut with Nylon-Insert Hex Locknut,SS	1

PROPRIETARY AND CONFIDENTIAL
THE INFORMATION CONTAINED IN THIS DRAWING IS THE SOLE PROPERTY OF FLEETWOOD WINDOWS & DOORS.
ANY REPRODUCTION IN PART OR AS A WHOLE WITHOUT THE WRITTEN PERMISSION OF FLEETWOOD WINDOWS & DOORS IS PROHIBITED.

TITLE: Series 3070 Assembly OX with screen	
DWG. NO. Series_3070_Assembly_Frame _OX_with screen	REV
DATE: 5/18/16	SHEET 1 OF 1