

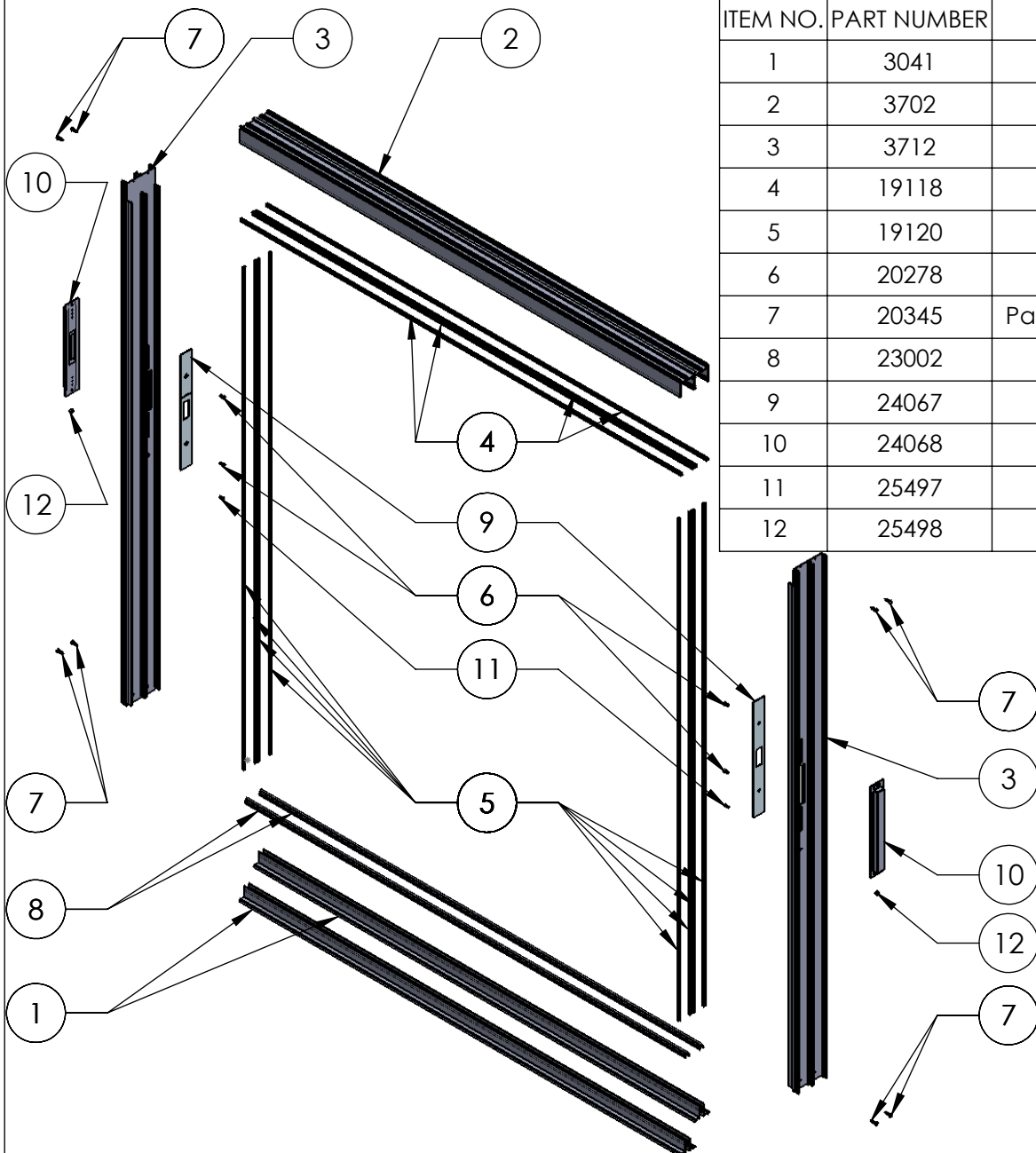

ASSEMBLY / PARTS LIST (B.O.M.)



ITEM NO.	PART NUMBER	DESCRIPTION	QTY.
1	3041	1.5 Hidden Track/Sill	2
2	3702	M/S Track Head	1
3	3712	M/S Track Jamb	2
4	19118	Weather Strip 23027045BKQB	4
5	19120	Q-Lon (u 5212)	8
6	20278	#10-32 FHP-B-UC, 9/16", SS CLEAR	4
7	20345	Pan Head Phillips Sheet Metal Screw NO 10 Size, 3/4" Length	8
8	23002	Stainless steel Track - 1/2" (Sliding Doors)	2
9	24067	Strike Plate	2
10	24068	Backup Plate (With Dust Cover)	2
11	25497	#8-32 FHP,UC, 1/2",SS	2
12	25498	#8-32 Nut with Nylon-Insert Hex Locknut,SS	2

PROPRIETARY AND CONFIDENTIAL
THE INFORMATION CONTAINED IN THIS DRAWING IS THE SOLE PROPERTY OF FLEETWOOD WINDOWS & DOORS.
ANY REPRODUCTION IN PART OR AS A WHOLE WITHOUT THE WRITTEN PERMISSION OF FLEETWOOD WINDOWS & DOORS IS PROHIBITED.

TITLE: Series 1050 Assembly XX Frame	
DWG. NO. Series_1050_Assembly_XX- Frame	REV
DATE: 1/9/15	SHEET 1 OF 1