

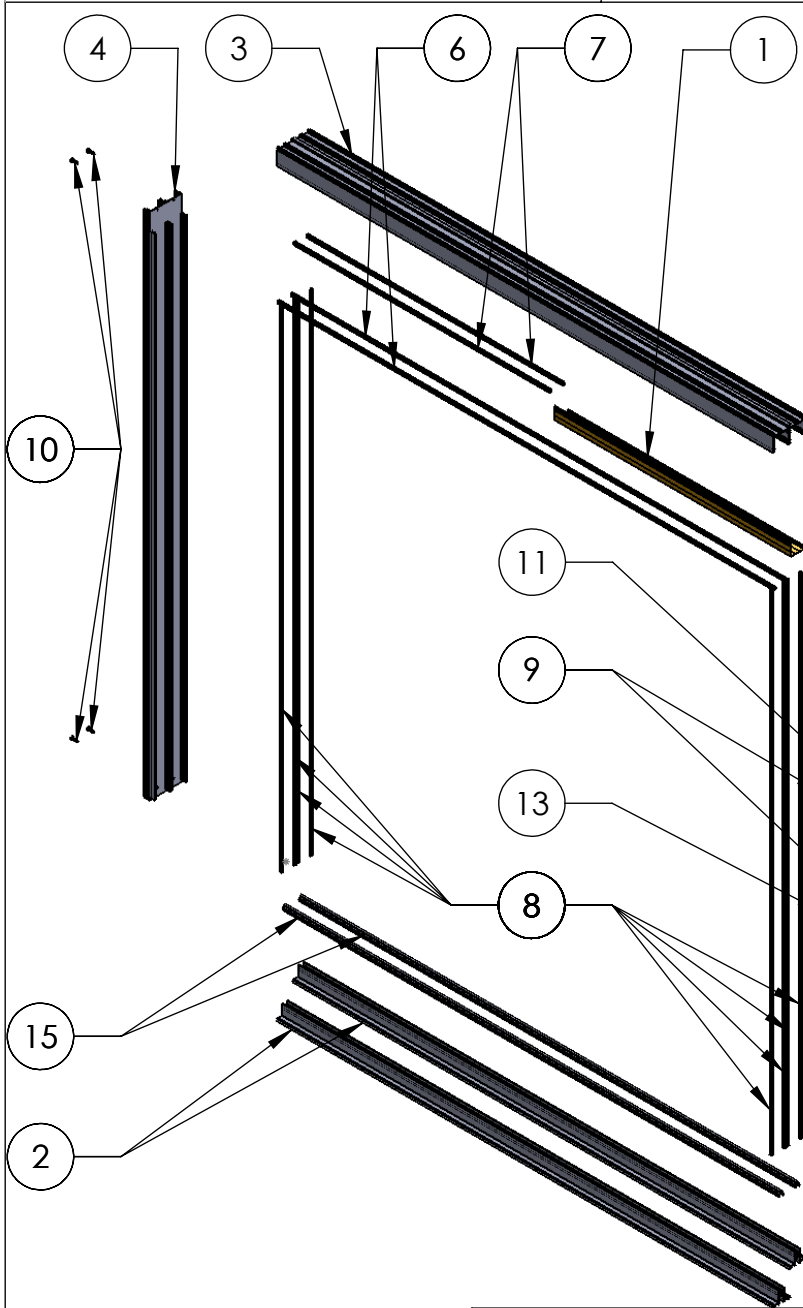

ASSEMBLY / PARTS LIST (B.O.M.)



ITEM NO.	PART NUMBER	DESCRIPTION	QTY.
1	3014	Head Filler/Closer	1
2	3041	1.5 Hidden Track/Sill	2
3	3702	M/S Track Head	1
4	3712	M/S Track Jamb	1
5	3712	M/S Track Jamb	1
6	19118	Weather Strip 23027045BKQB	2
7	19118	Weather Strip 23027045BKQB	2
8	19120	Q-Lon (u 5212)	8
9	20278	# 10-32 FHP-B-UC, 9/16", SS CLEAR	2
10	20345	Pan Head Phillips Sheet Metal Screw NO 10 Size, 3/4" Length	8
11	24067	Strike Plate	1
12	24068	Backup Plate (With Dust Cover)	1
13	25497	#8-32 FHP,UC, 1/2",SS	1
14	25498	#8-32 Nut with Nylon-Insert Hex Locknut,SS	1
15	FW1020	Stainless steel Track - 9/16" (Sliding Doors)	2

PROPRIETARY AND CONFIDENTIAL
THE INFORMATION CONTAINED IN THIS DRAWING IS THE SOLE PROPERTY OF FLEETWOOD WINDOWS & DOORS.
ANY REPRODUCTION IN PART OR AS A WHOLE WITHOUT THE WRITTEN PERMISSION OF FLEETWOOD WINDOWS & DOORS IS PROHIBITED.

TITLE: Series 1050 Assembly OX Frame	
DWG. NO. Series_1050_Assembly_ OX-Frame	REV
DATE: 1/9/15	SHEET 1 OF 1